

MERIDEN PUBLIC SCHOOLS ADMINISTRATIVE OFFICES ROOF REPLACEMENT

STATE OF CONNECTICUT PROJECT NO. 080-0098RR

31 JANUARY 2024

CITY OF MERIDEN

THE HONORABLE KEVIN M. SCARPATI, MAYOR

BRUCE A. FONTANELLA, DEPUTY MAYOR

MARK D. BENIGNI, Ed.D., SUPERINTENDENT OF SCHOOLS

MICHAEL S. GROVE, ASSISTANT SUPERINTENDENT FOR TECHNOLOGY AND OPERATIONS

RAWLE DUMMETT, PURCHASING OFFICER

SCHOOL BUILDING COMMITTEE

STEPHEN KOGUT	CHAIRPERSON
BRUCE A. FONTANELLA	VICE CHAIRPERSON
BARBARA FRASER	SECRETARY
CHRIS DREAHER	MEMBER
MARK HUGHES	MEMBER
RONALD KOGUT	MEMBER
ROBERT LORENZO	MEMBER
TONY MARTORELLI	MEMBER
LILLIAN RIVERA-HICKS	MEMBER

CITY COUNCIL

DAN BRUNET
MICHAEL CARABETTA
CHAD CARDILLO
YVETTE CORTEZ
BRUCE A. FONTANELLA
LARUE A. GRAHAM
SONYA R. JELKS
RAY R. OUELLET
MICHAEL S. ROHDE
JOSEPH SCARAMUZZO
BOB WILLIAMS, JR.
MICHAEL ZAKRZEWSKI

BOARD OF EDUCATION

ROBERT E. KOSIENSKI, JR.	PRESIDENT
KIM A. CARBONE-PANDIANI	VICE PRESIDENT
DR. STEVEN J. O'DONNELL	SECRETARY
ALLAN E. PRONOVOST	TREASURER
SHERI L. AMECH	MEMBER
NICKIMMY C. HAYES	MEMBER
ENILEIKA LOPEZ-RIDDLE	MEMBER
SIOBHAN K. MALONEY-BAZINET	MEMBER
ANTONIO A. MARTORELLI, III	MEMBER



P.O. BOX 787, MERIDEN, CONNECTICUT 06450
TELEPHONE (203) 639-0804

© 2024 ANDRADE ARCHITECTS LLC

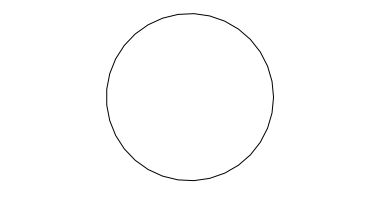

DRAWING LIST	
NO.	NAME
A0.00	COVER
A0.10	SITE LIMITATIONS
A1.30	ROOF PLAN
A7.50	ROOFING DETAILS
A7.51	ROOFING DETAILS
A7.52	ROOFING DETAILS
HM-101	ASBESTOS ABATEMENT PLAN

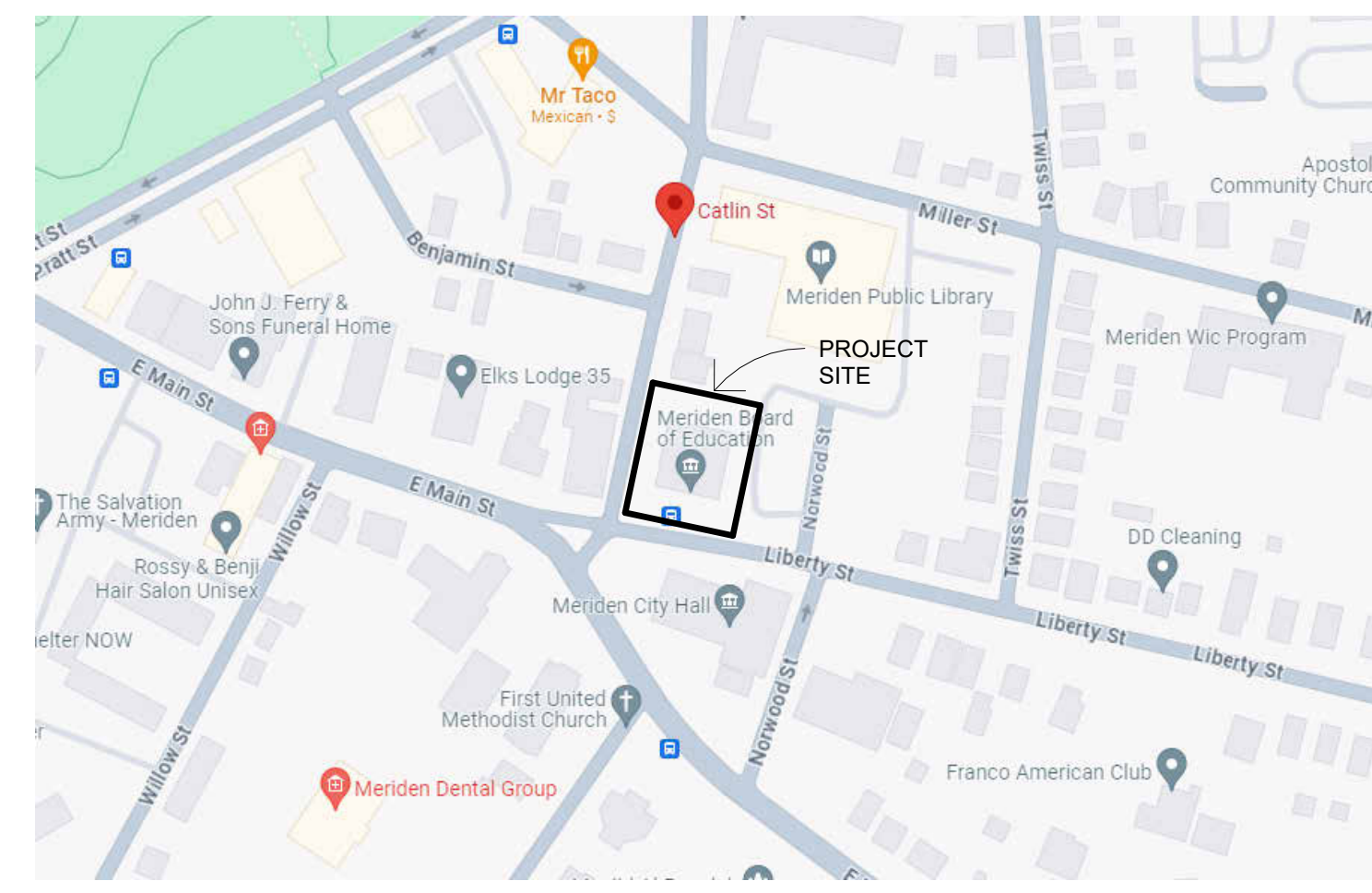

LOCATION MAP

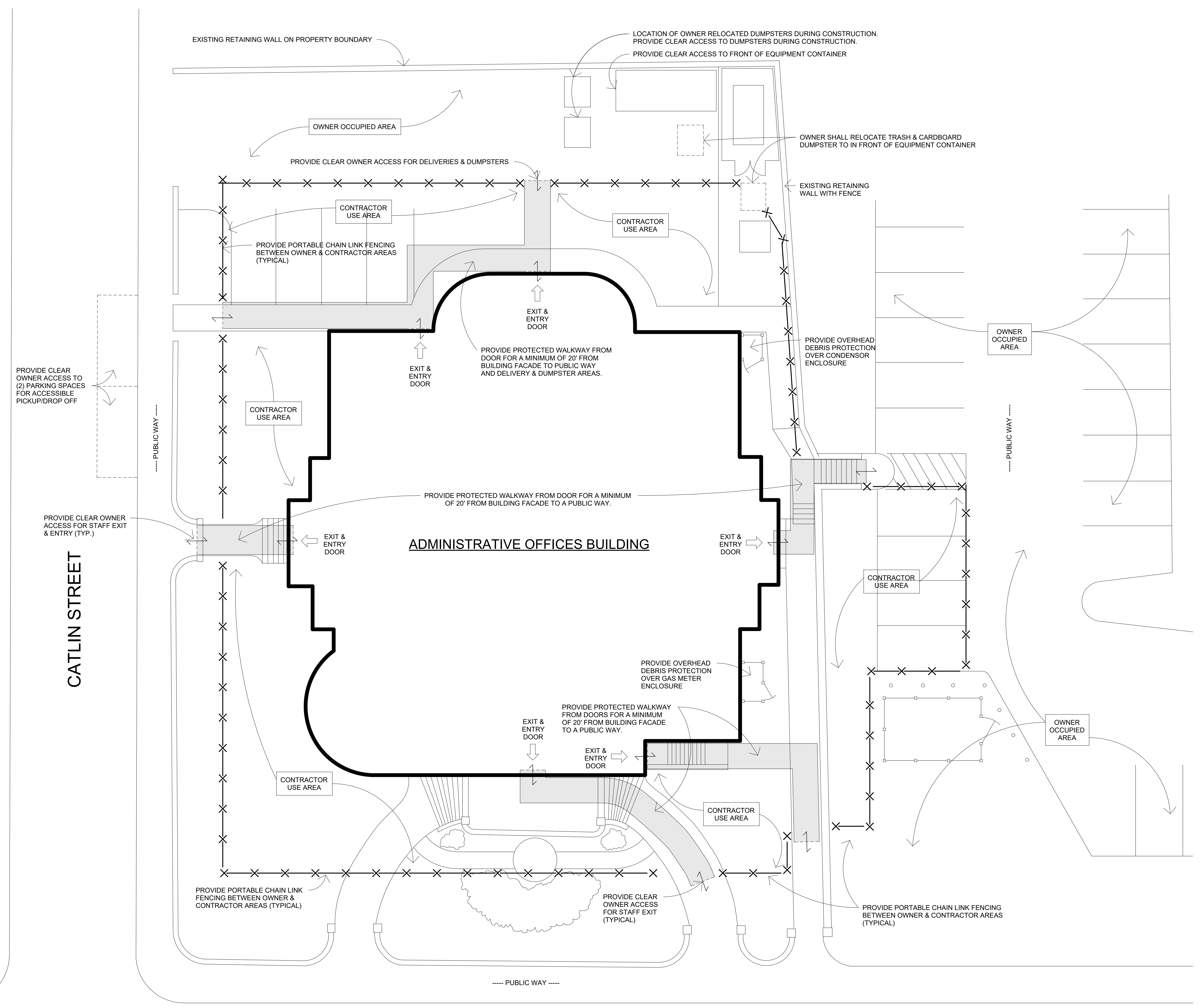
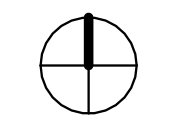

ROOFING REPLACEMENT

MERIDEN PUBLIC SCHOOLS ADMINISTRATIVE OFFICES

22 LIBERTY STREET
MERIDEN, CT 06450

STATE PROJECT NO.: 080-00989



© 2023 ANDRADE ARCHITECTS LLC

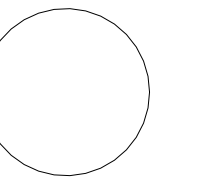

ENVIRONMENTAL ENGINEERS:
FRUSS & O'NEILL, INC.
146 HARTFORD ROAD
MANCHESTER, CT 06040
T (860) 386-2463

LIGHTNING PROTECTION:
BEWIS ASSOCIATES LLC
155 MAIN ST
FARMINGTON, CT 06032
T (860) 687-3333

DATE: 31 JANUARY 2024

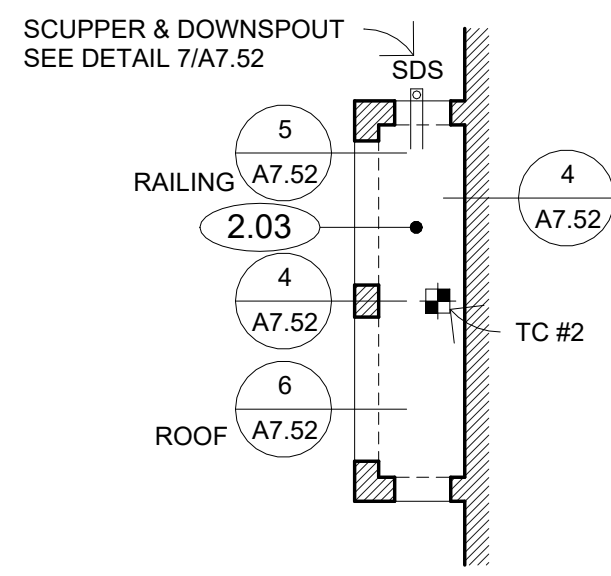

6 ROOF PLAN - SECOND FLOOR WEST
1/8" = 1'-0"

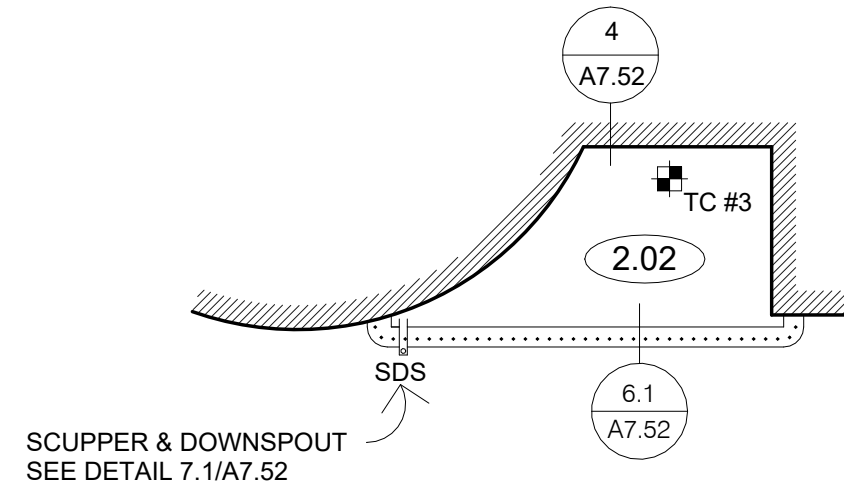

5 ROOF PLAN - SECOND FLOOR SOUTH
1/8" = 1'-0"

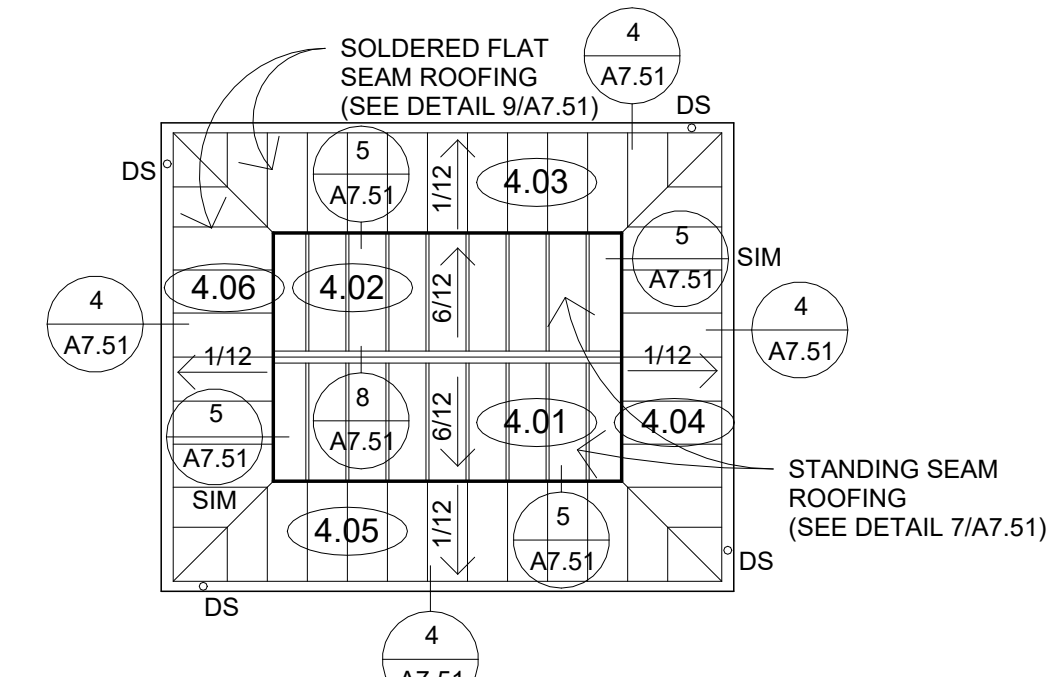

4 ROOF PLAN - CLERESTORY
1/8" = 1'-0"

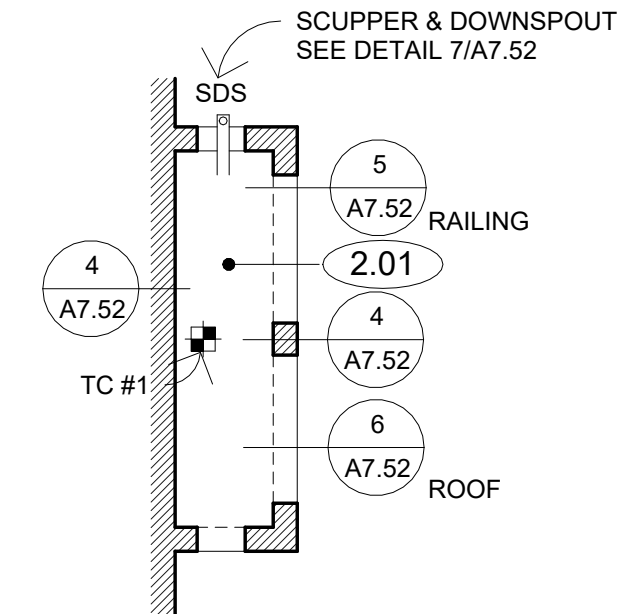

3 ROOF PLAN - SECOND FLOOR EAST
1/8" = 1'-0"

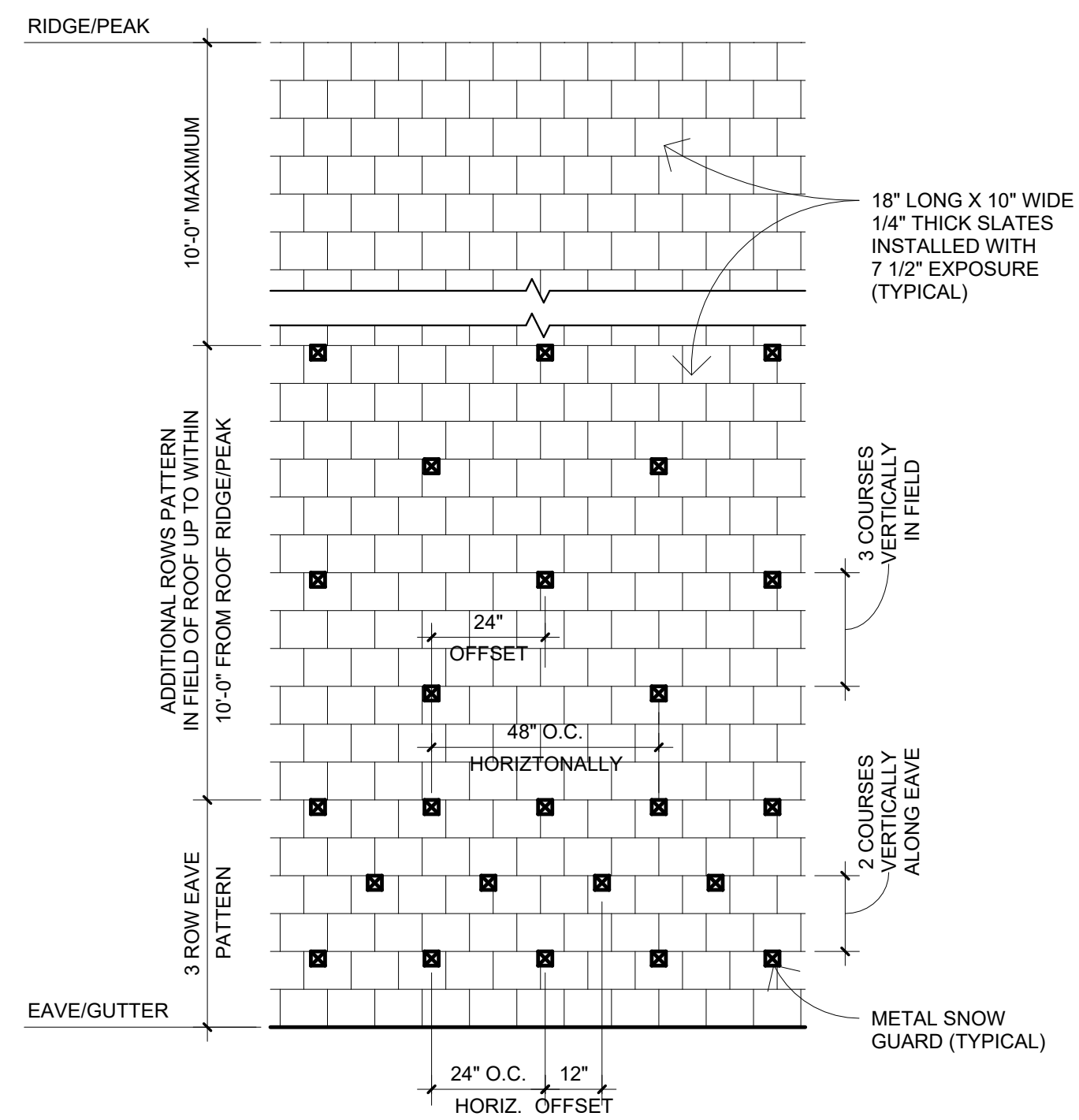

7 TYPICAL SLATE ROOFING SNOW GUARD SPACING
3/8" = 1'-0"

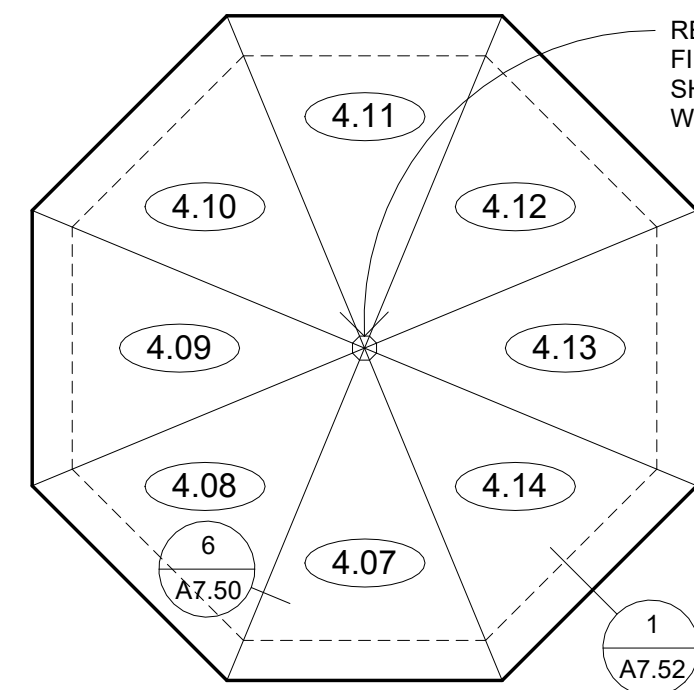

2 ROOF PLAN - TOWER
1/8" = 1'-0"

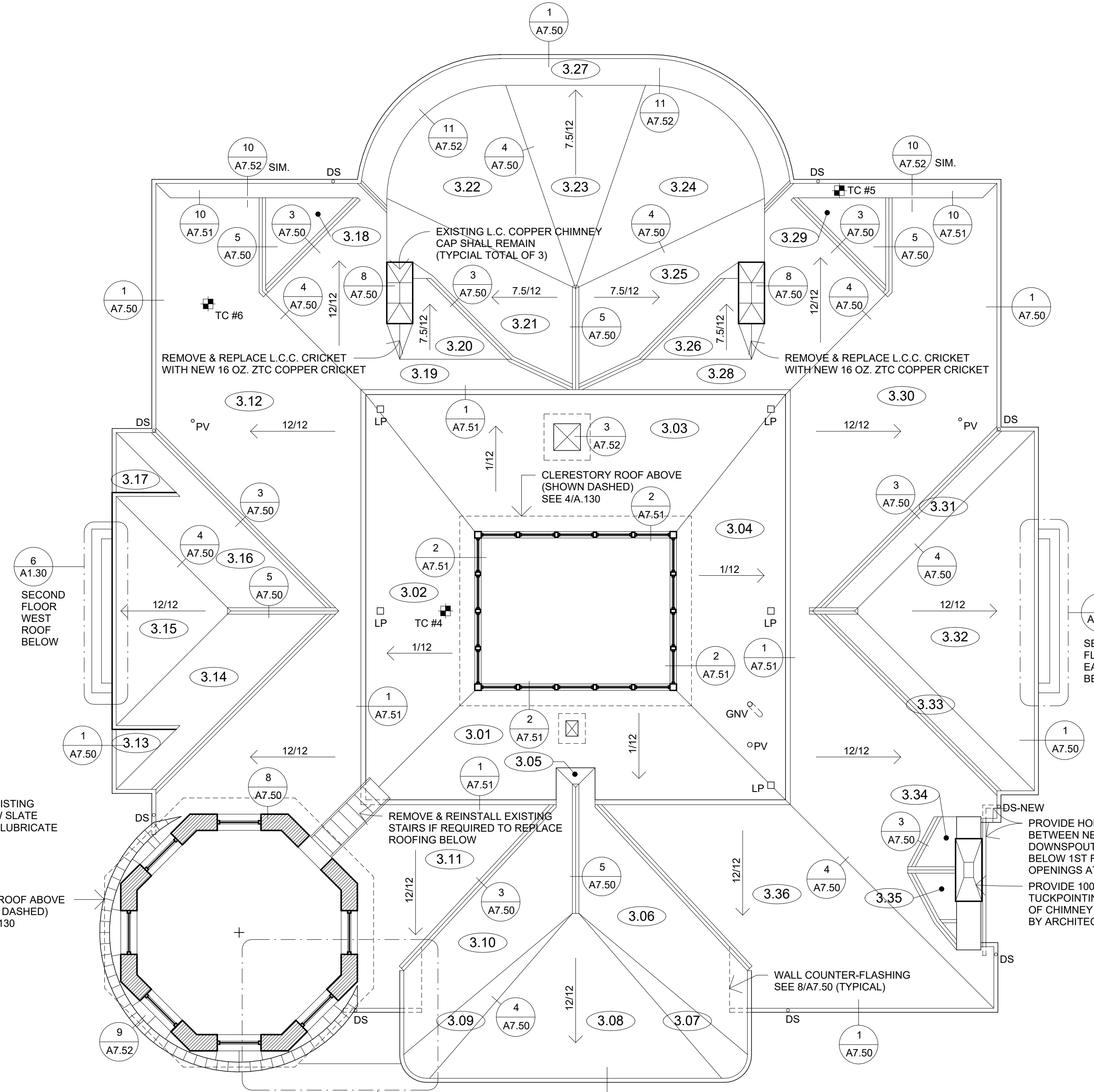

1 ROOF - THIRD FLOOR
1/8" = 1'-0"

5 SECOND FLOOR SOUTH ROOF BELOW
1/8" = 1'-0"

ROOF PLAN LEGEND

- DOWNSPOUT (SEE DETAIL 8/A7.52)
- SCUPPER & DOWNSPOUT (SEE DETAIL 7/A7.52)
- PLUMBING VENT (SEE DETAIL 7/A7.50 - SLATE) (SEE DETAIL 3/A7.51 - EPDM)
- LIGHTNING PROTECTION (SEE DETAIL 6/A7.51)
- ROOFING TEST CUT WITH NUMBER. REFER TO INFO. AVAILABLE IN MANUAL.
- AIR SUPPLY/EXHAUST OR FAN CURB (SEE DETAIL 3/A7.52)
- GOOSE NECK VENT (SEE DETAIL 8/A7.51)
- ROOF SURFACE ID # SEQUENTIAL NUMBER ROOF LEVEL

ROOF PLAN

A1.30

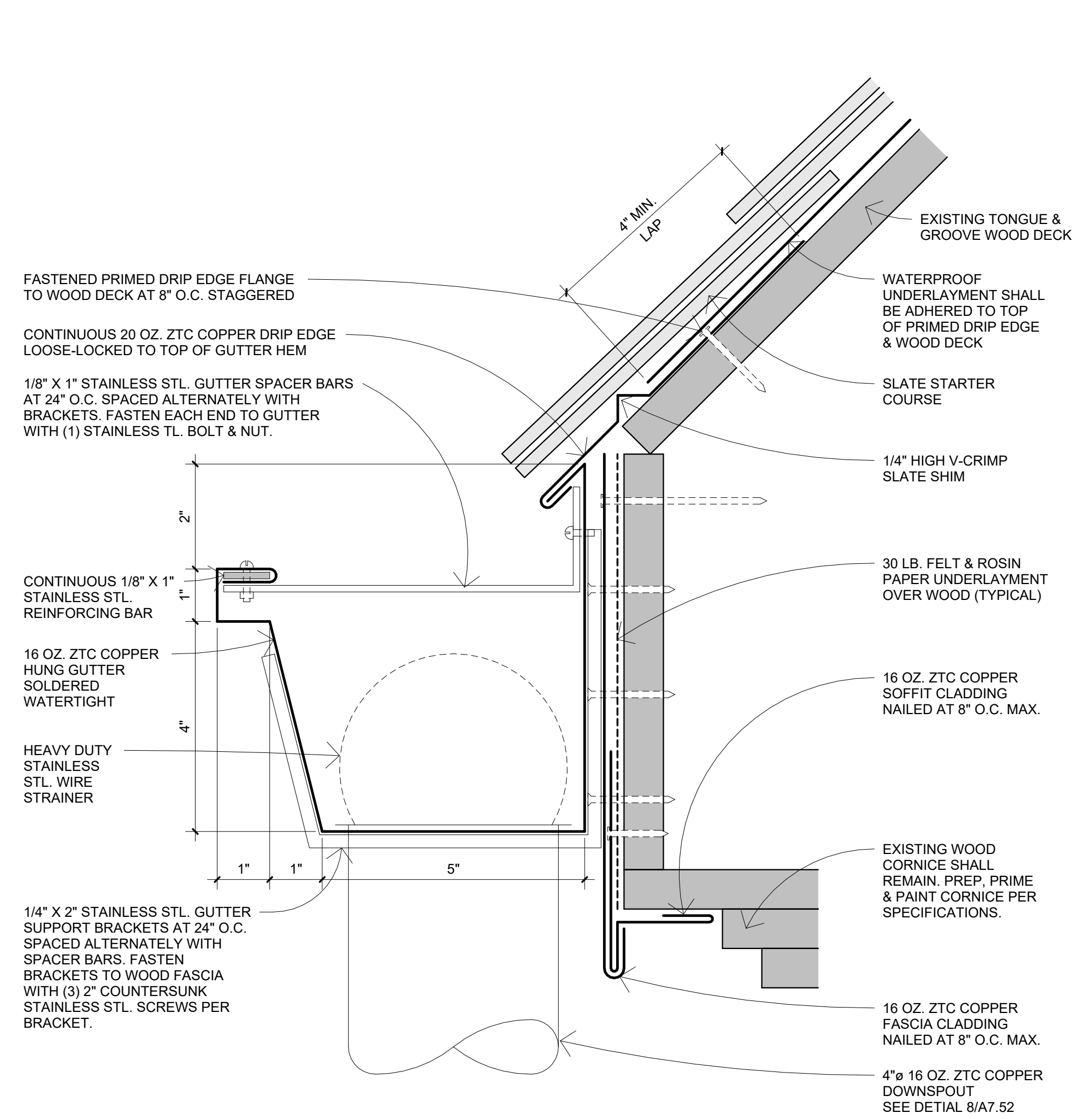
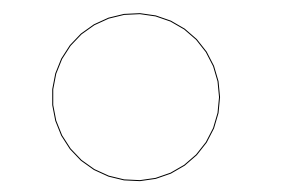

2 TYPICAL SLATE ROOF GUTTER
6" = 1'-0"

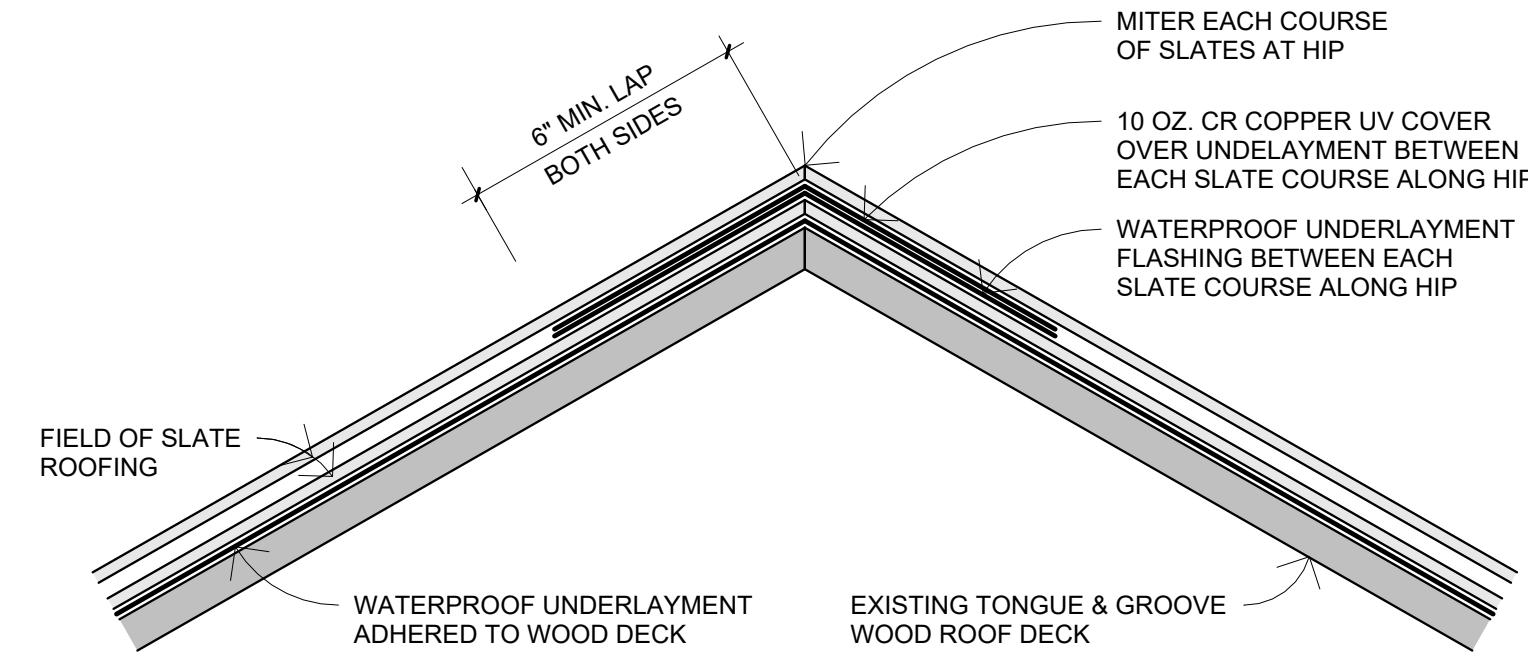

6 TOWER SLATE ROOFING MITERED HIP FLASHING
3" = 1'-0"

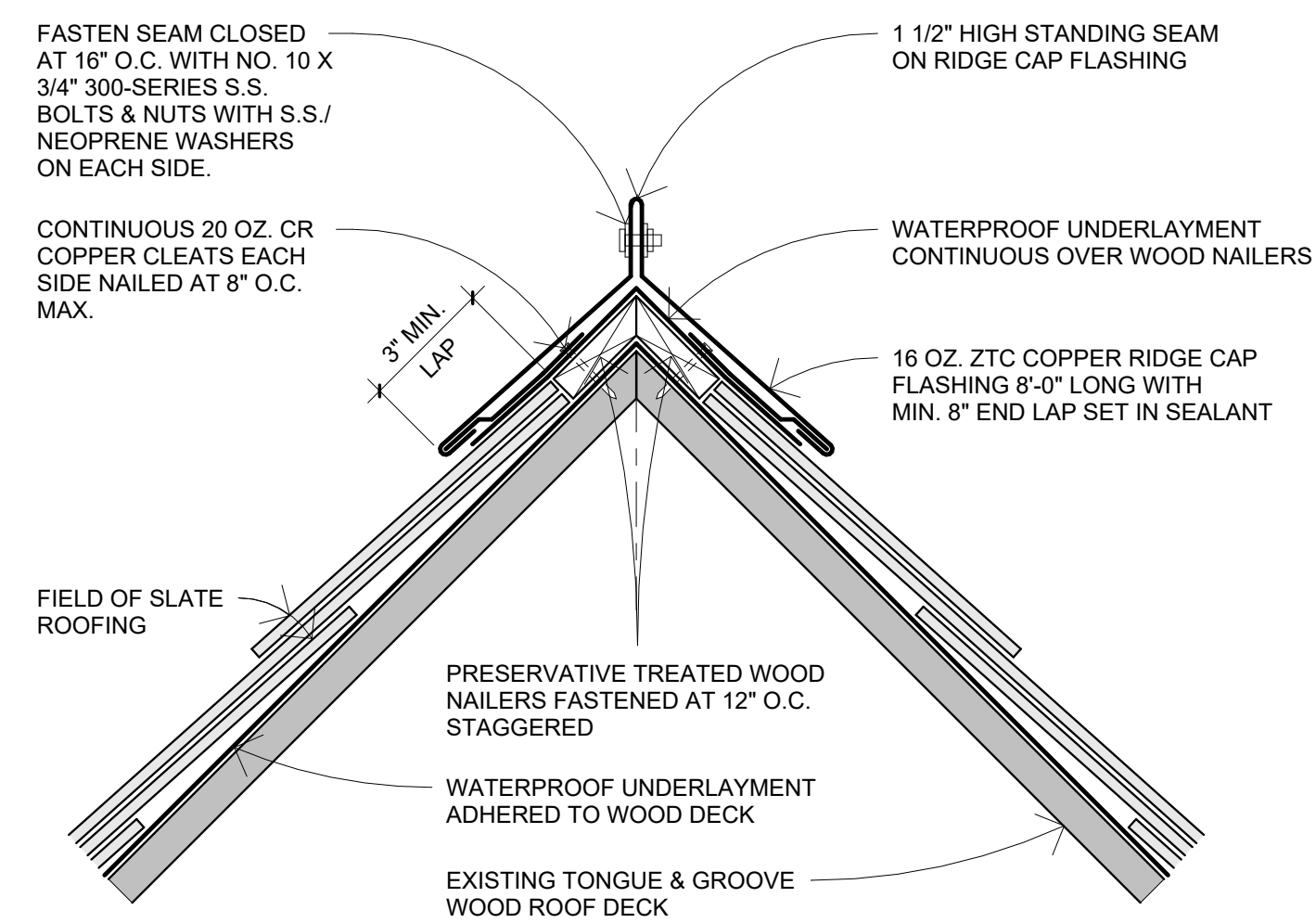

5 TYPICAL SLATE ROOFING RIDGE CAP FLASHING
3" = 1'-0"

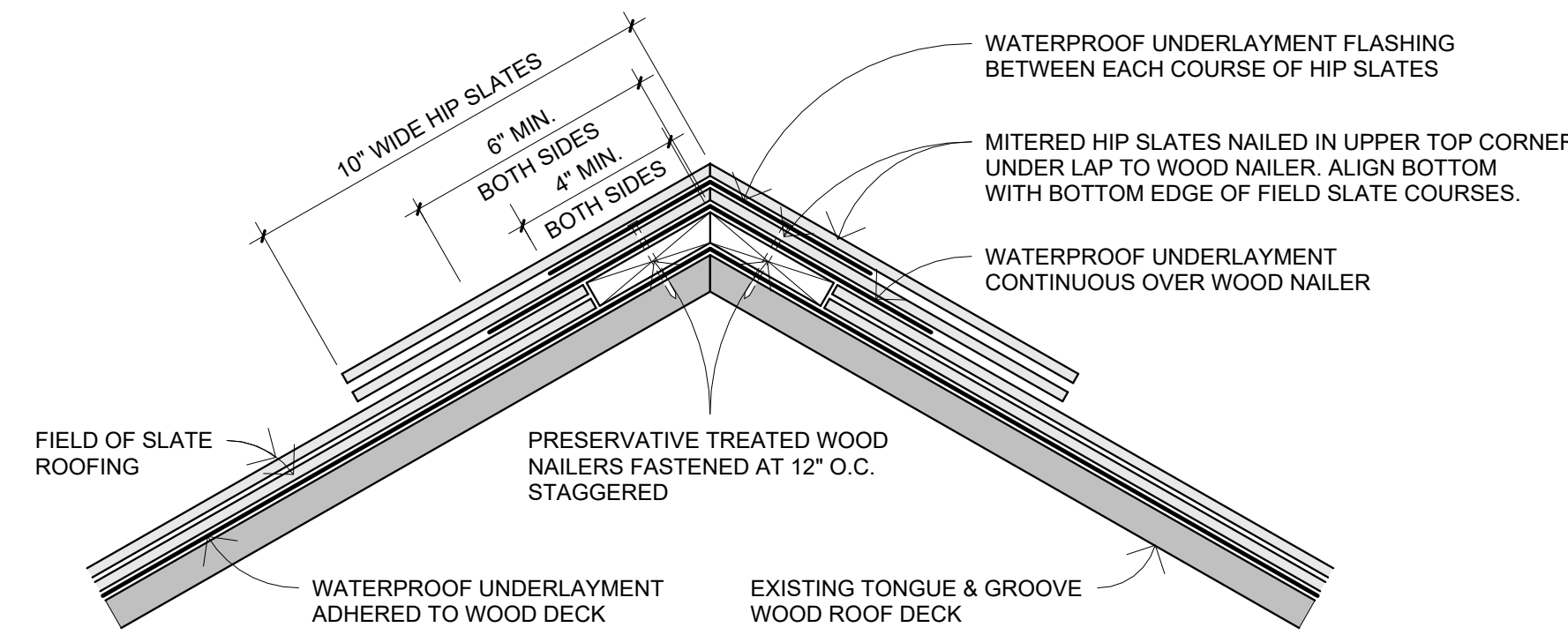

4 TYPICAL SLATE ROOFING SADDLE HIP FLASHING
3" = 1'-0"

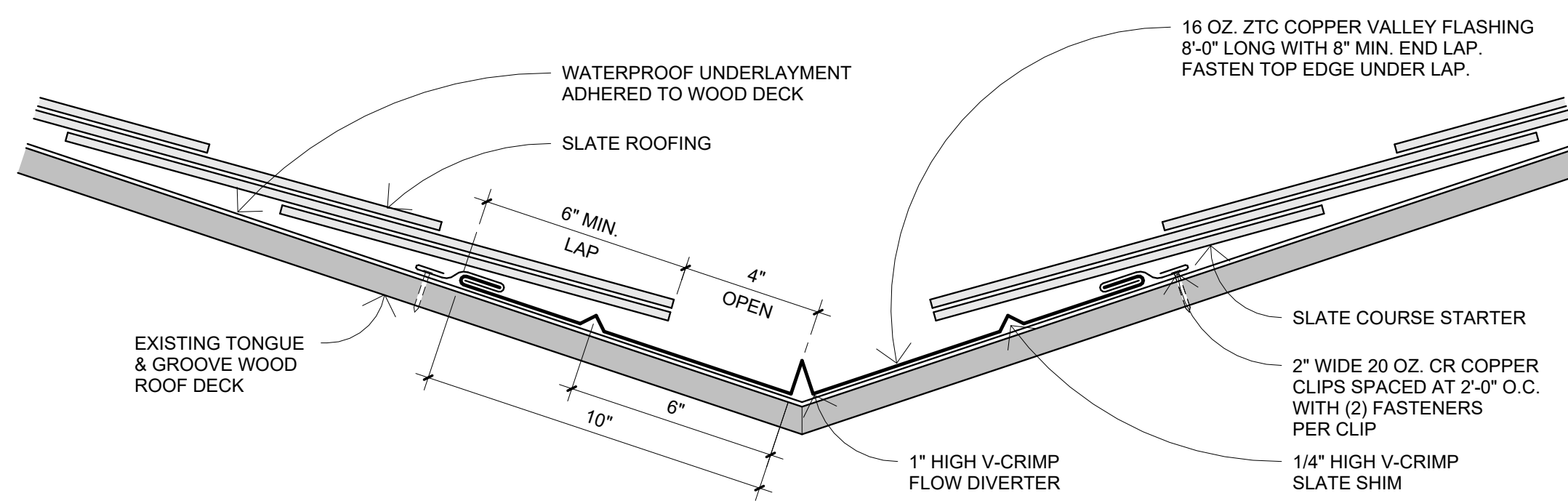

3 TYPICAL SLATE ROOFING OPEN VALLEY FLASHING
3" = 1'-0"

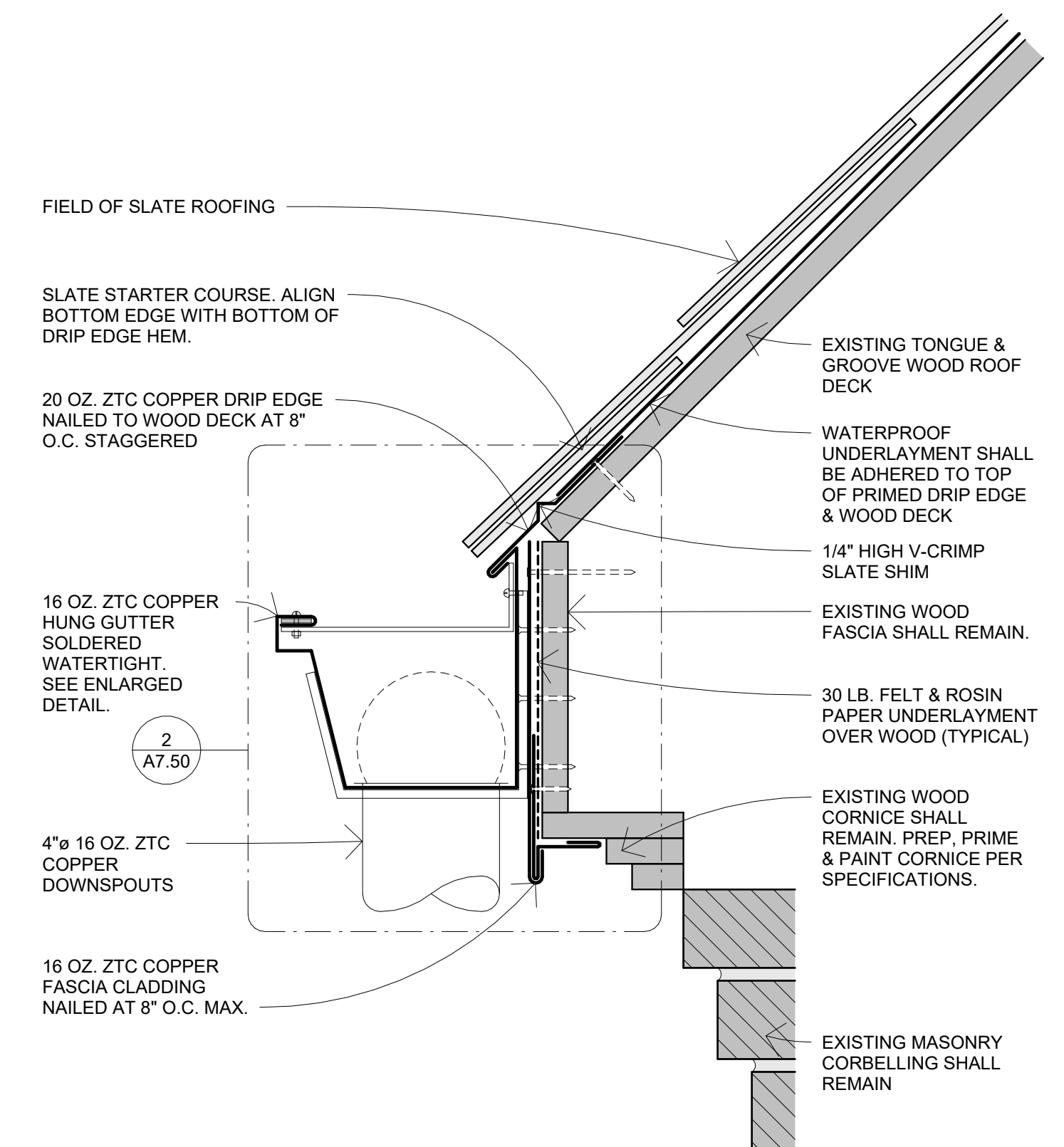

1 TYPICAL SLATE ROOFING EAVE
3" = 1'-0"

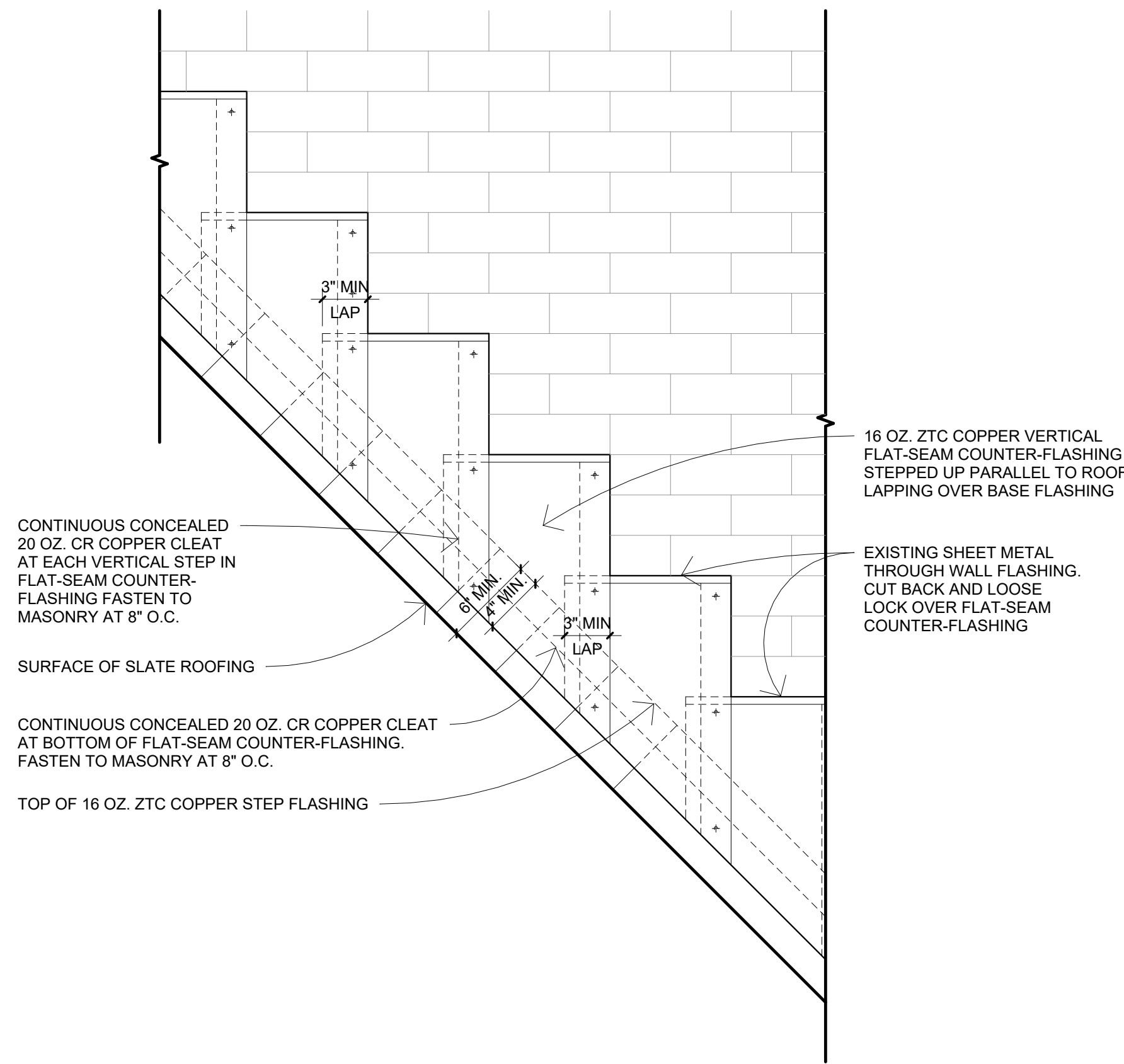

8 TYPICAL STEPPED FLAT-SEAM COUNTER-FLASHING ELEVATION
1 1/2" = 1'-0"

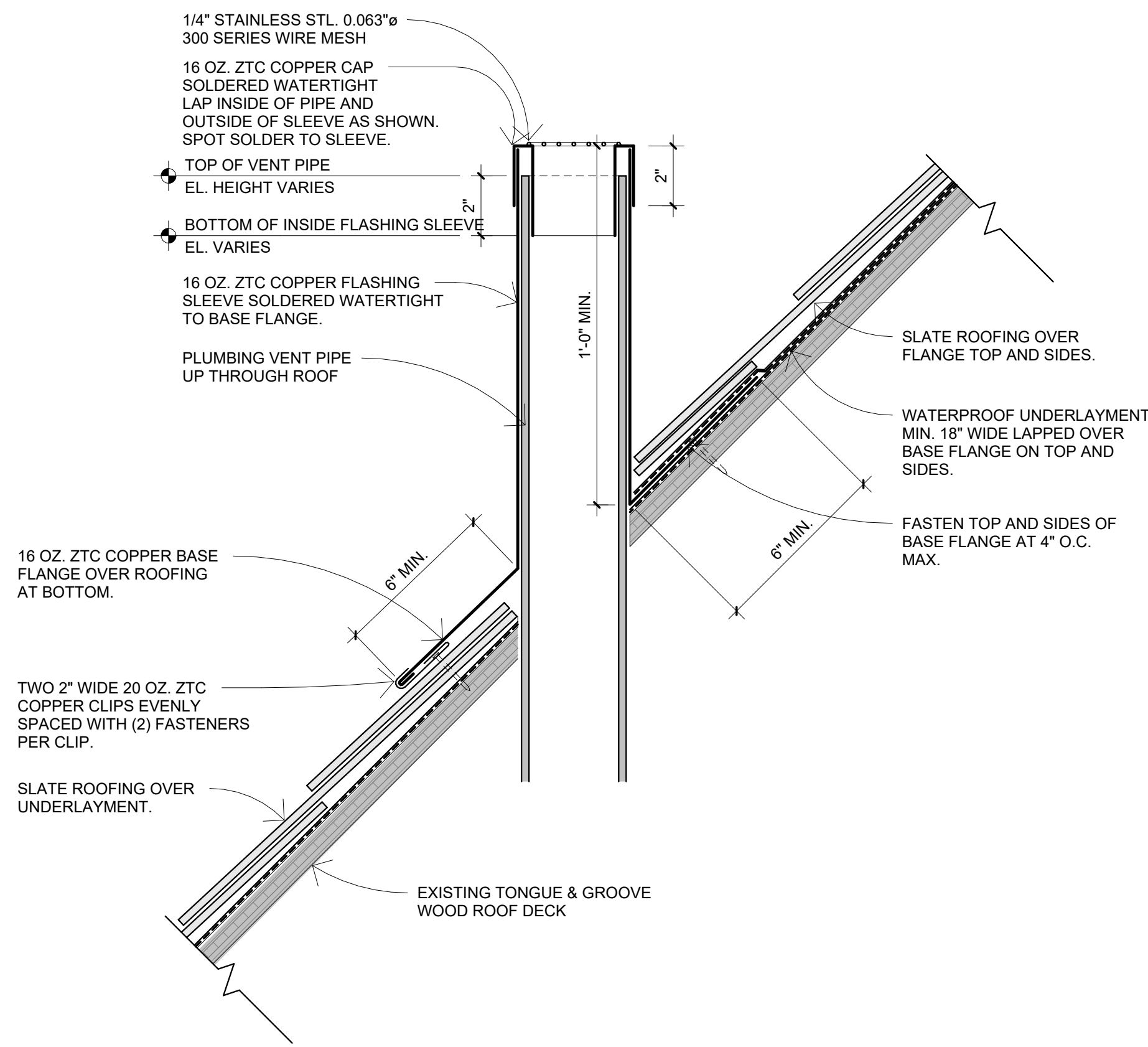

7 TYPICAL SLATE ROOFING PLUMBING VENT LASHING
3" = 1'-0"

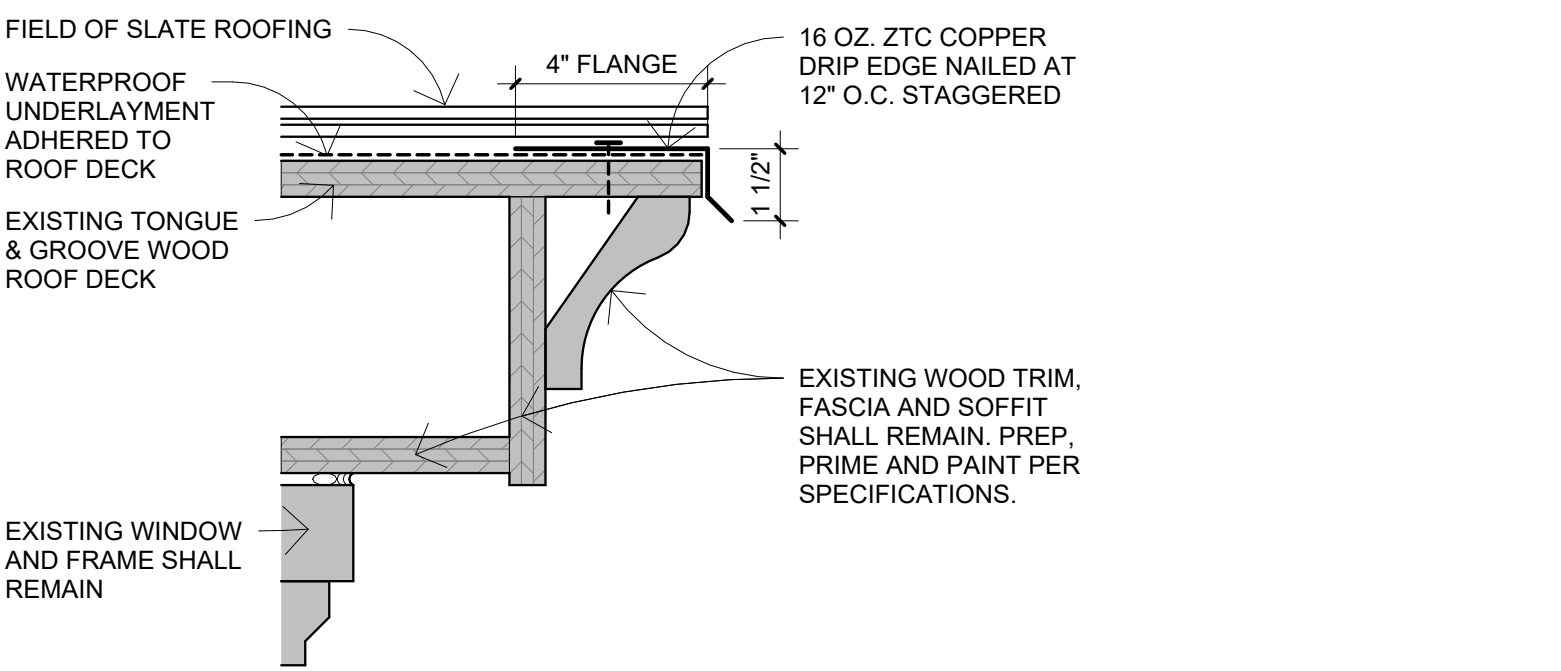
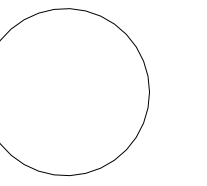

10 TYPICAL SLATE ROOFING RAKE 3" = 1'-0"

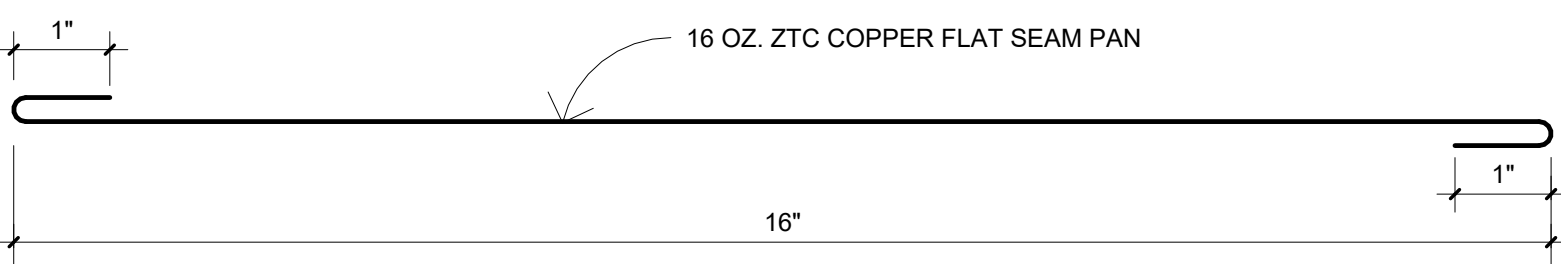

SHOP FABRICATED PAN FROM 18" SHEET

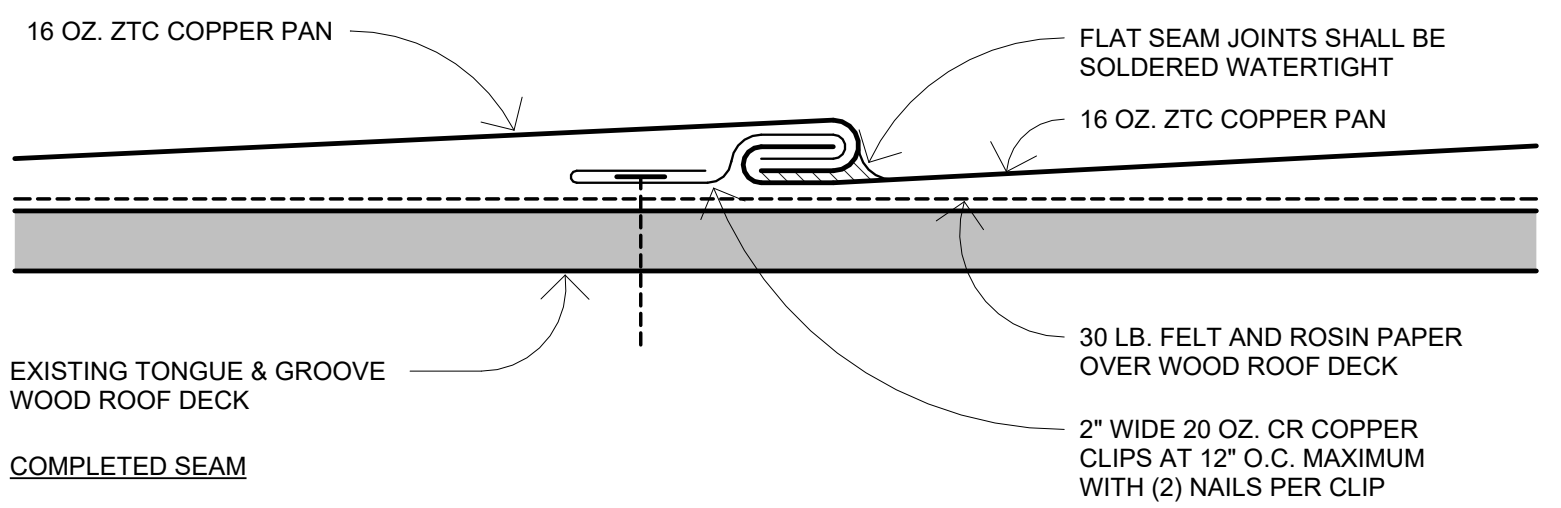

9 TYPICAL SOLDERED FLAT SEAM ROOFING DETAIL 6" = 1'-0"

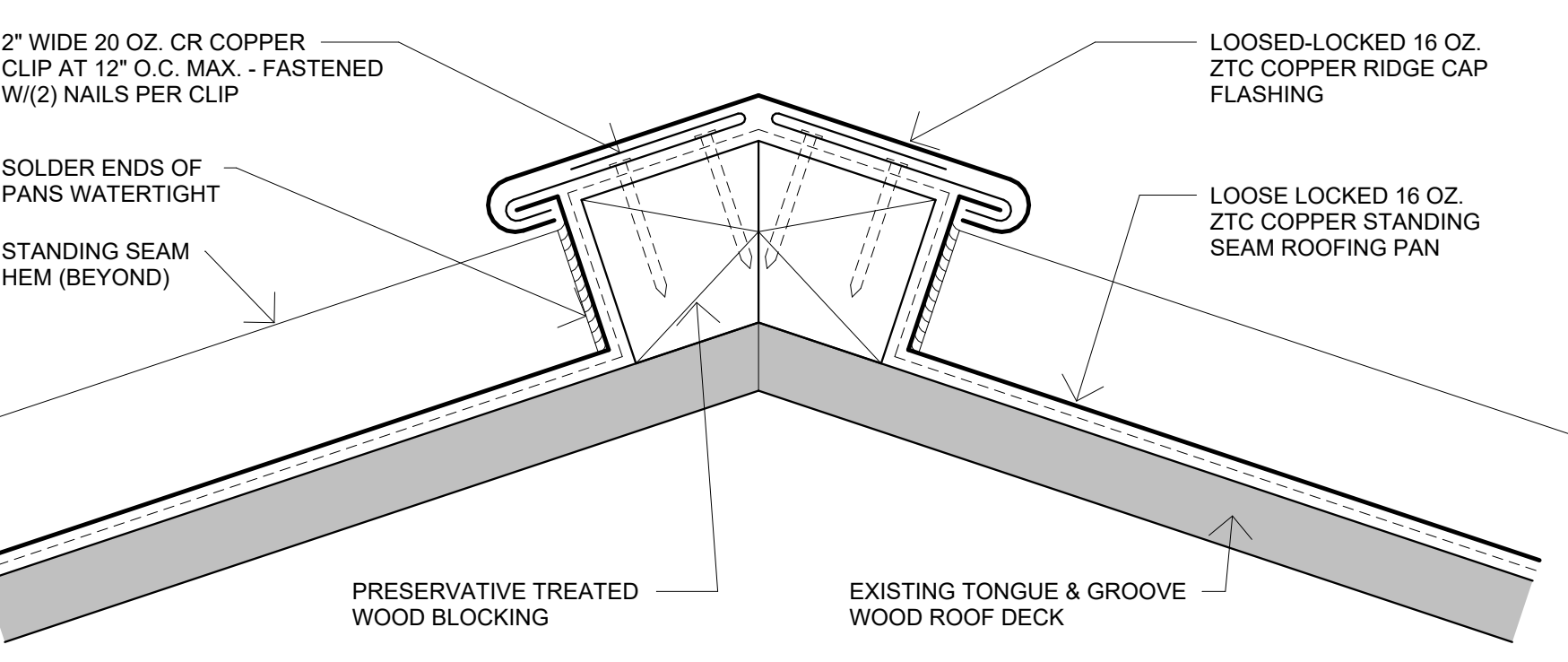

8 TYPICAL STANDING SEAM ROOF RIDGE/HIP FLASHING DETAIL 6" = 1'-0"

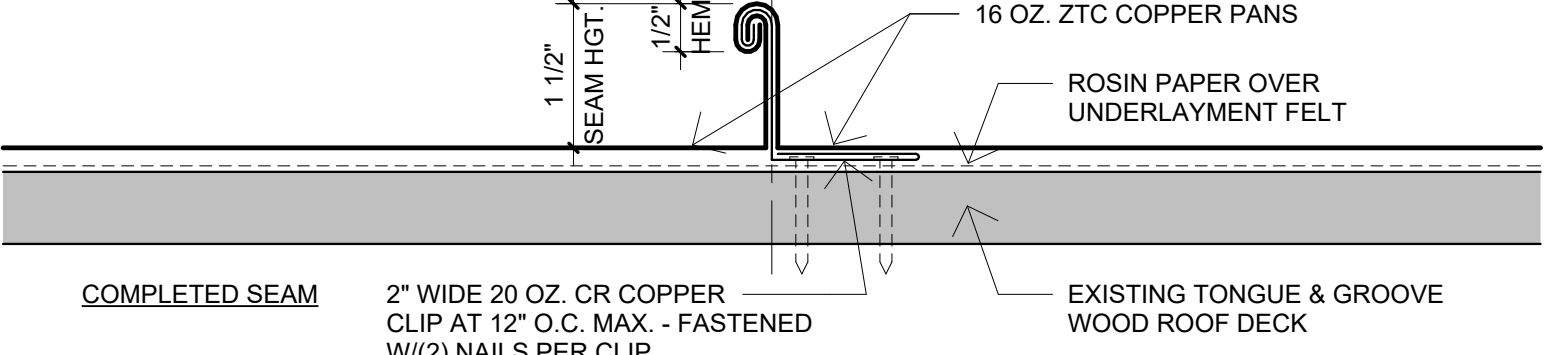
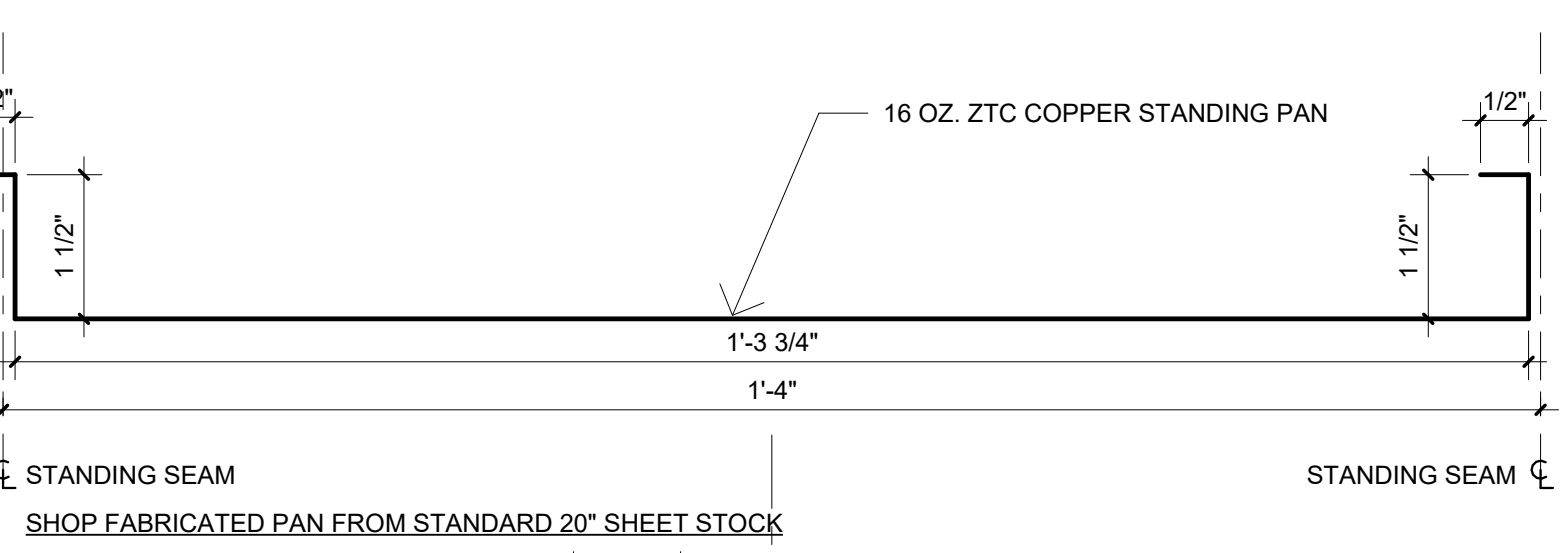

NOTE: DETAIL 7.1 SIMILAR TO DETAIL 7 EXCEPT NOMINAL PAN WIDTHS 1'-0" WIDE IN LIEU OF 1'-4" WIDE.

7 TYPICAL STANDING SEAM ROOFING DETAIL 6" = 1'-0"

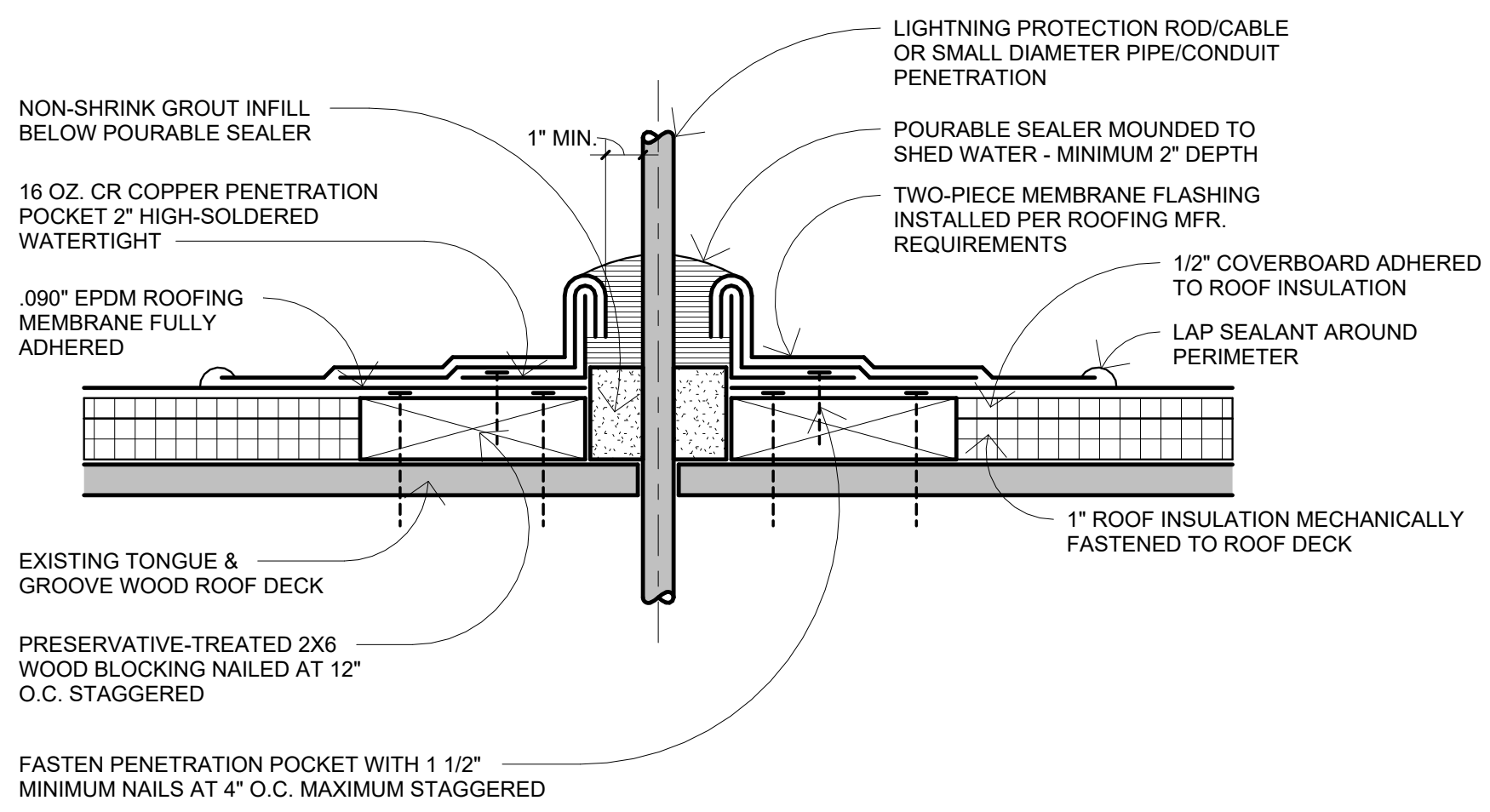

6 POURABLE SEALER PENETRATION POCKET FLASHING 3" = 1'-0"

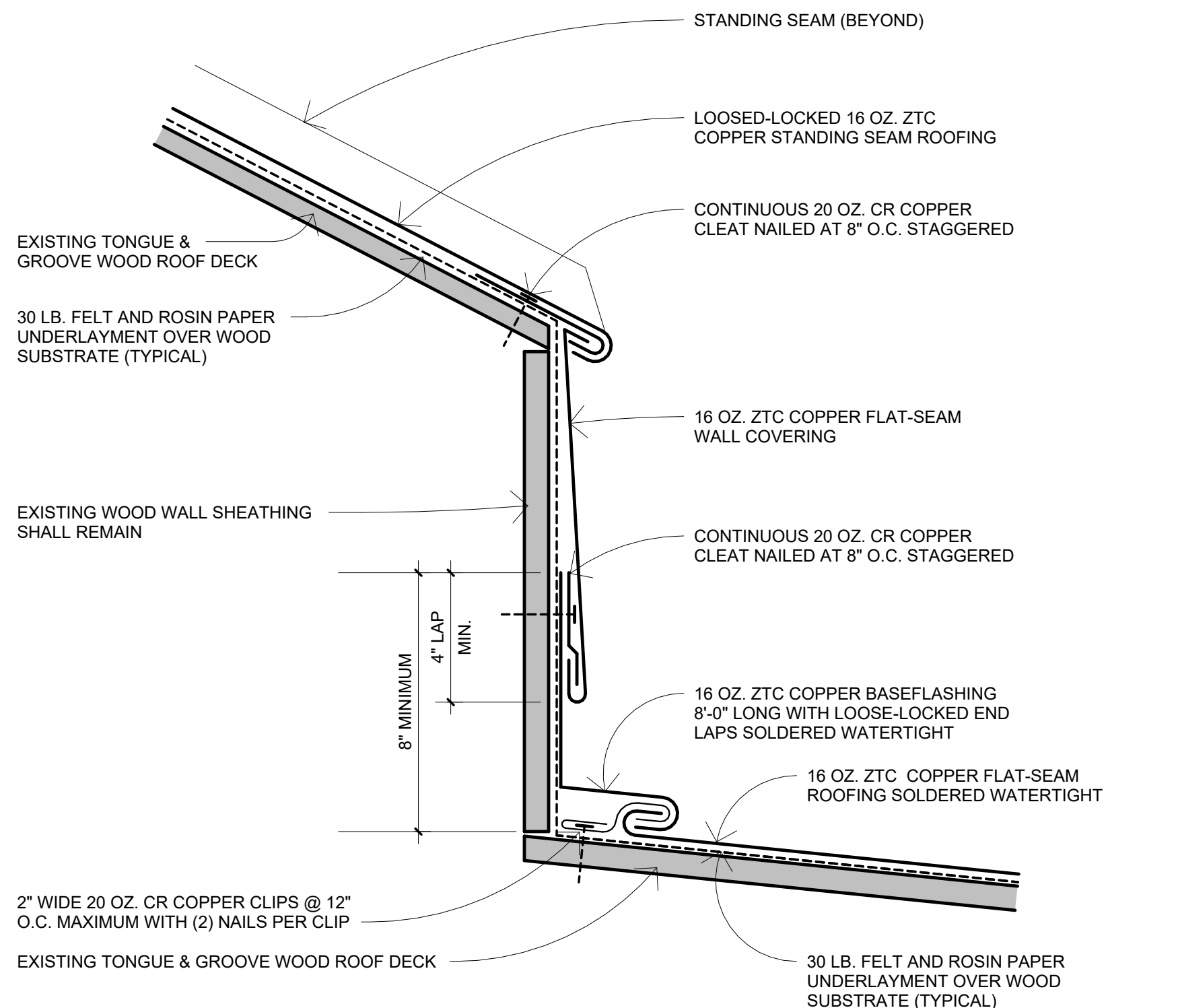

5 ROOF TRANSITION CLADDING - STANDING SEAM TO FLAT SEAM ROOFS 3" = 1'-0"

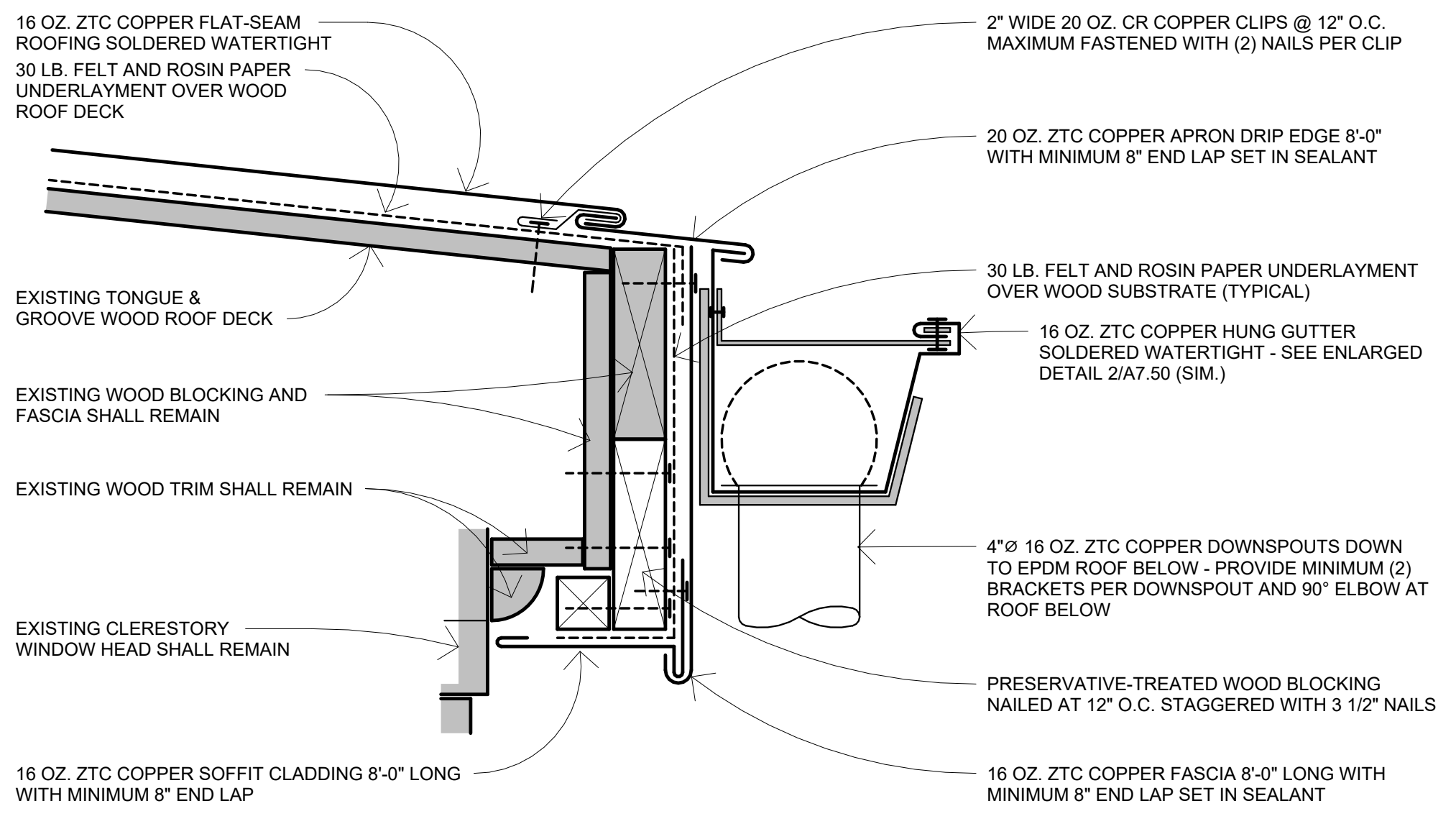

4 TYPICAL FLAT-SEAM COPPER CLERESTORY ROOFING EAVE 3" = 1'-0"

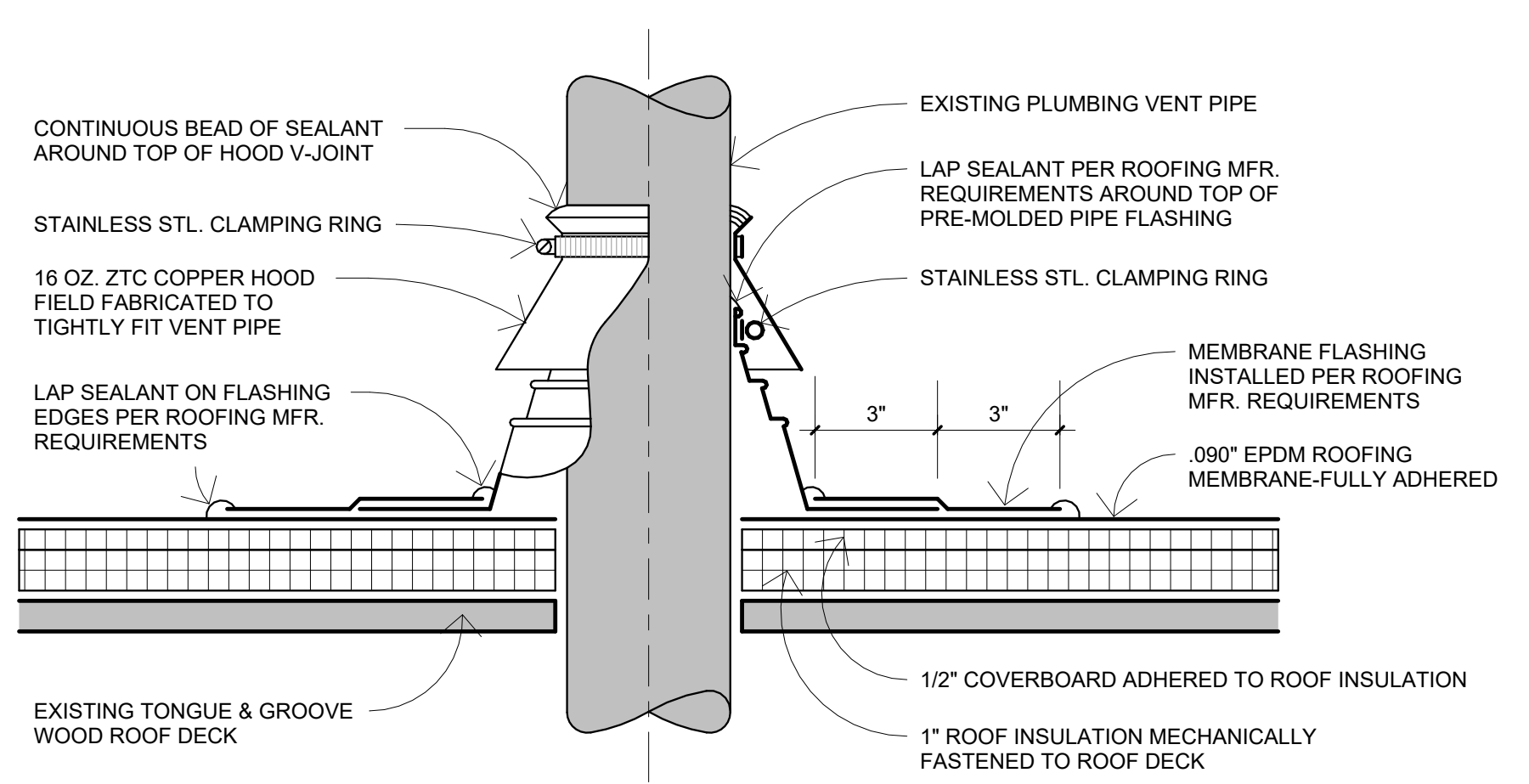

3 TYPICAL EPDM ROOFING PLUMBING VENT FLASHING 3" = 1'-0"

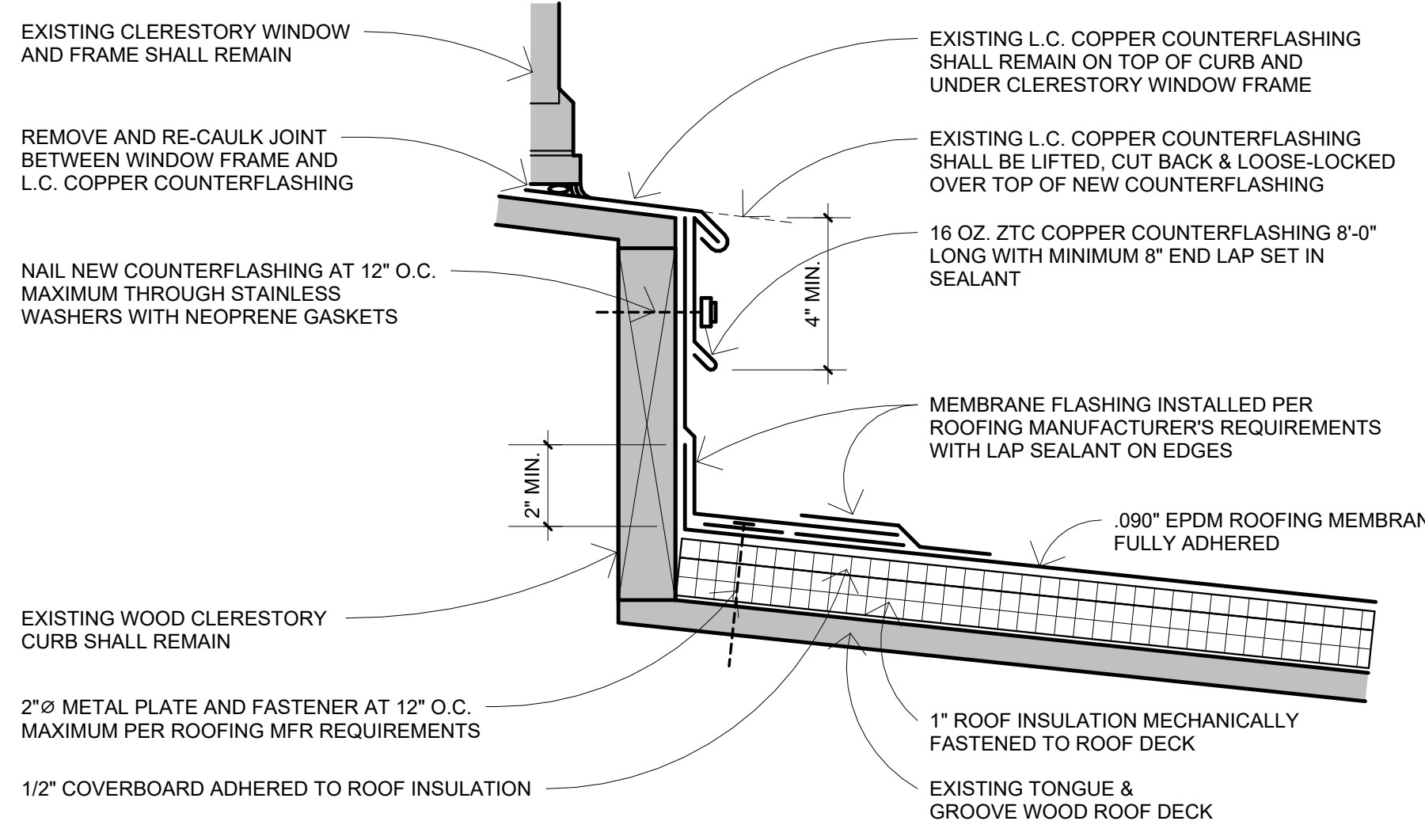

2 CLERESTORY CURB BASE FLASHING 3" = 1'-0"

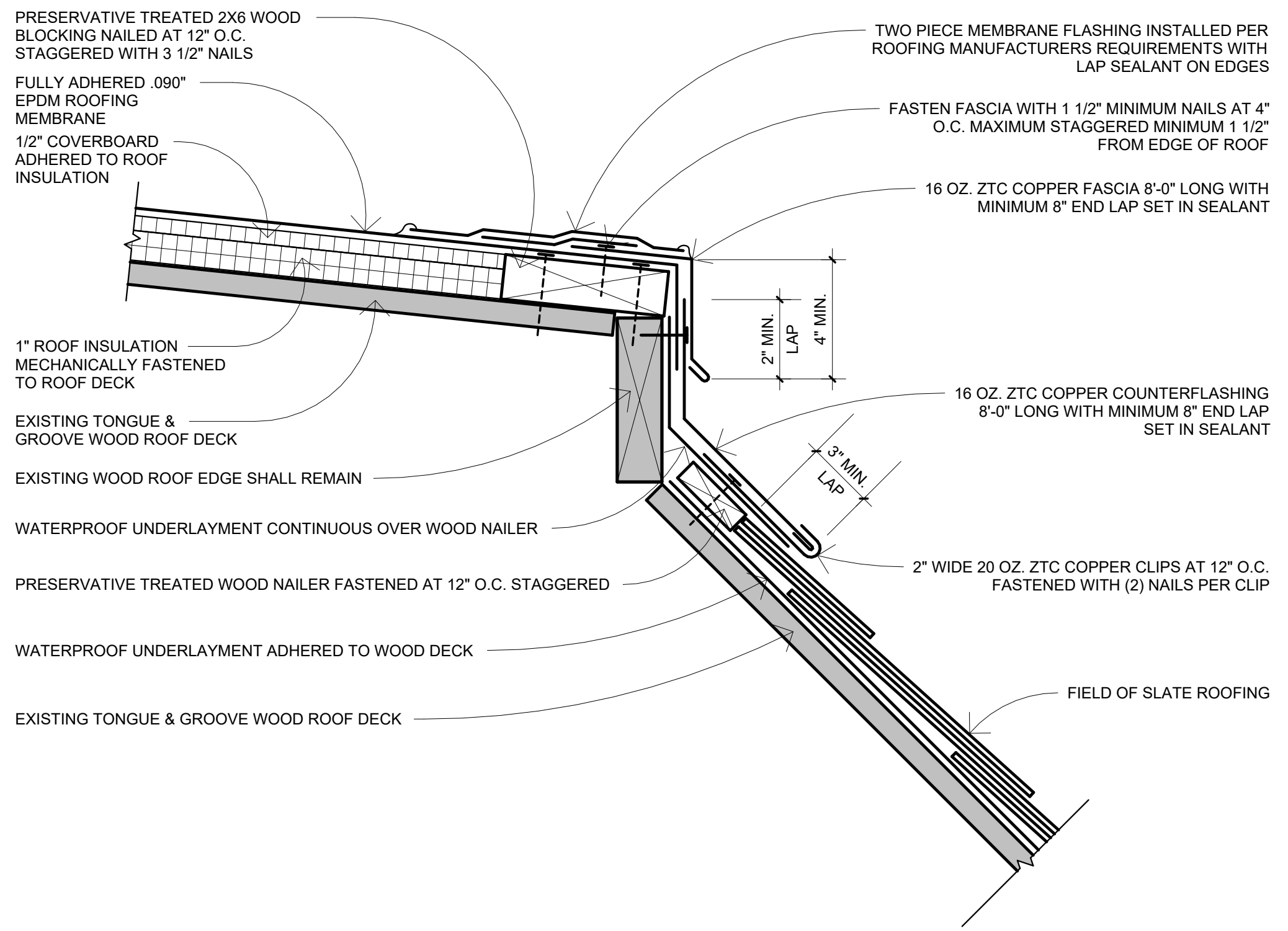

1 ROOF TRANSITION FLASHING - EPDM TO SLATE 3" = 1'-0"

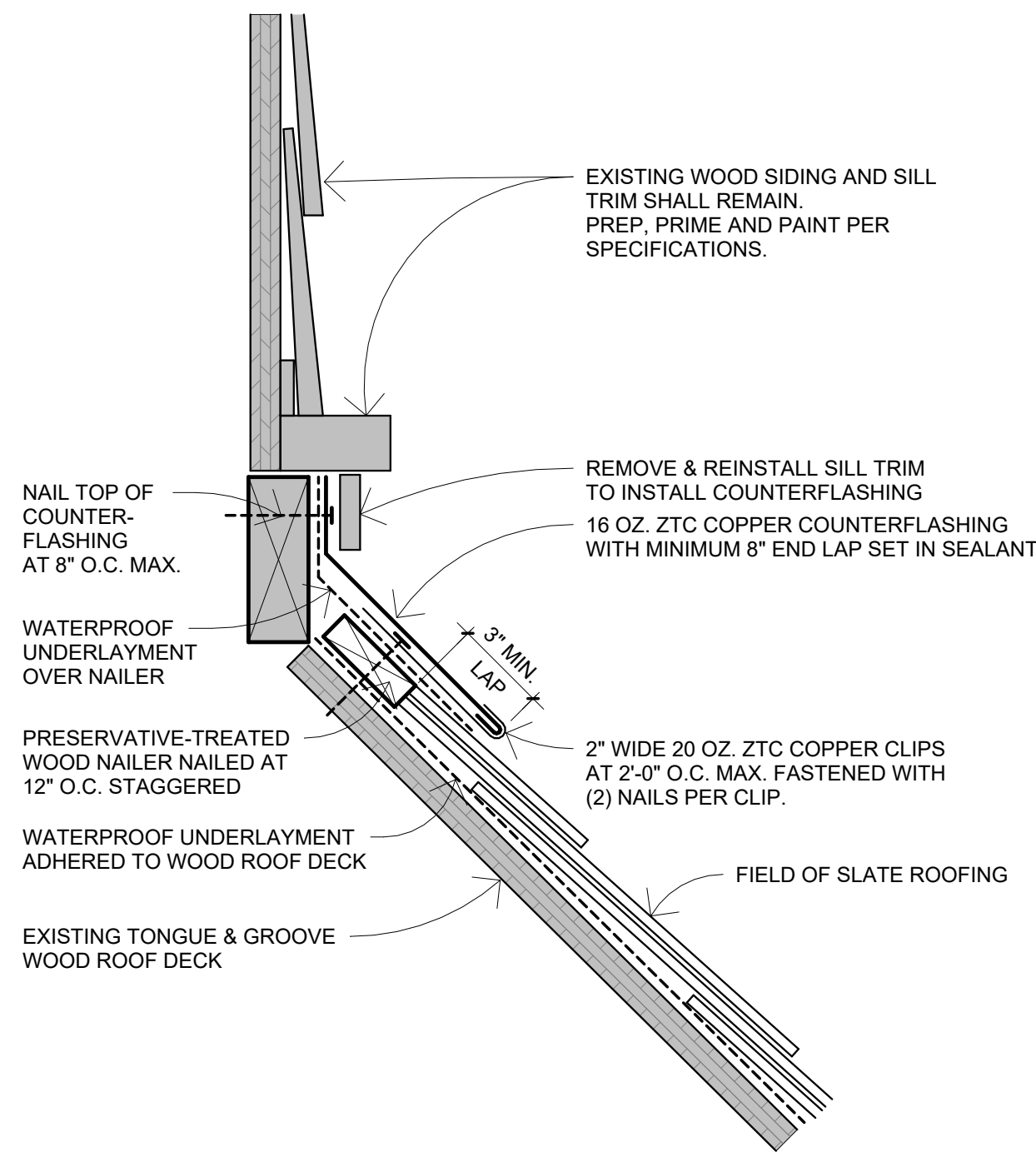
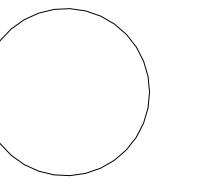

10 SLATE ROOF COUNTERFLASHING
A7.52 3" = 1'-0"

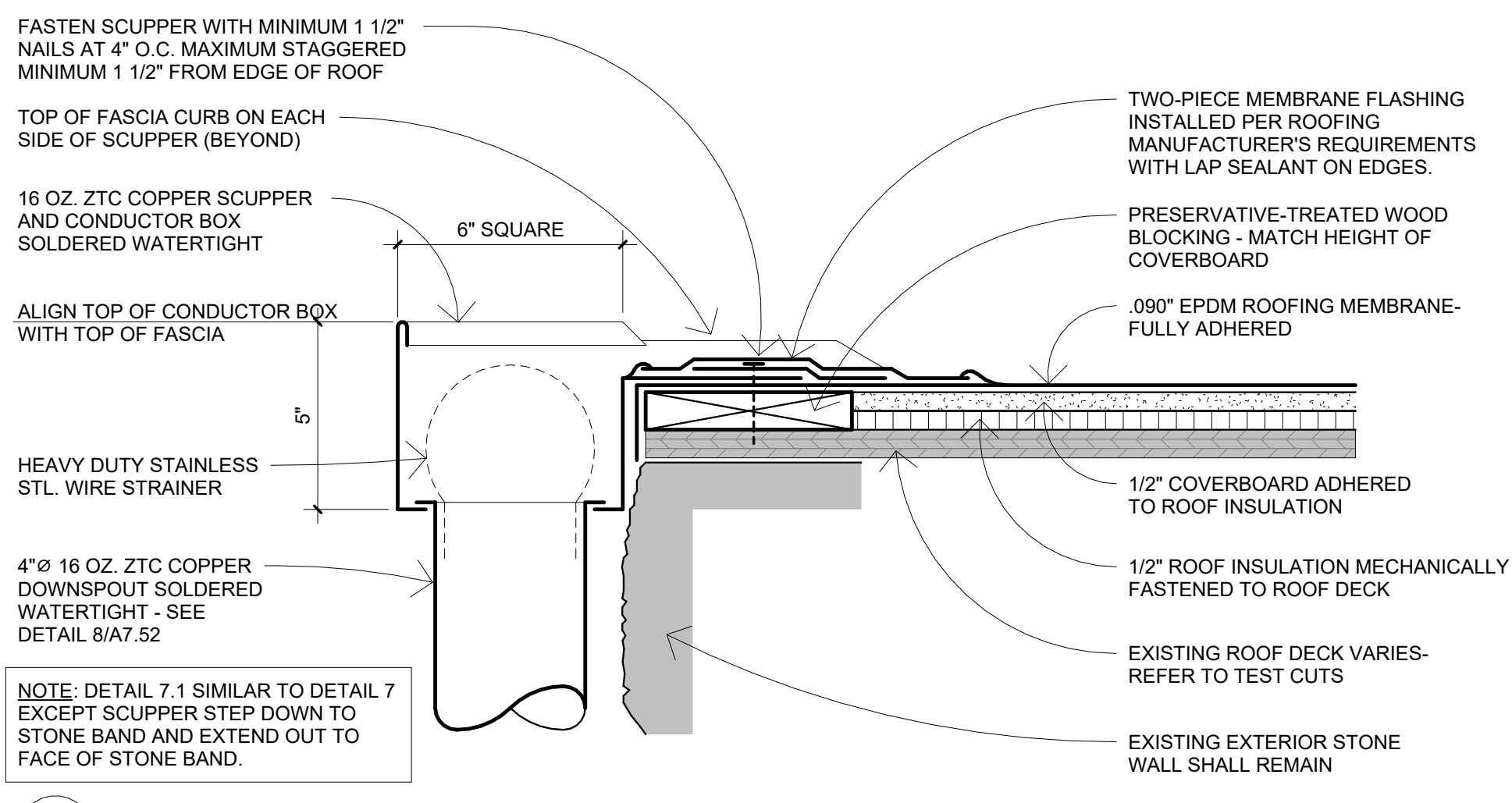

7 TYPICAL SECOND FLOOR EPDM ROOF SCUPPER FLASHING
A7.52 3" = 1'-0"

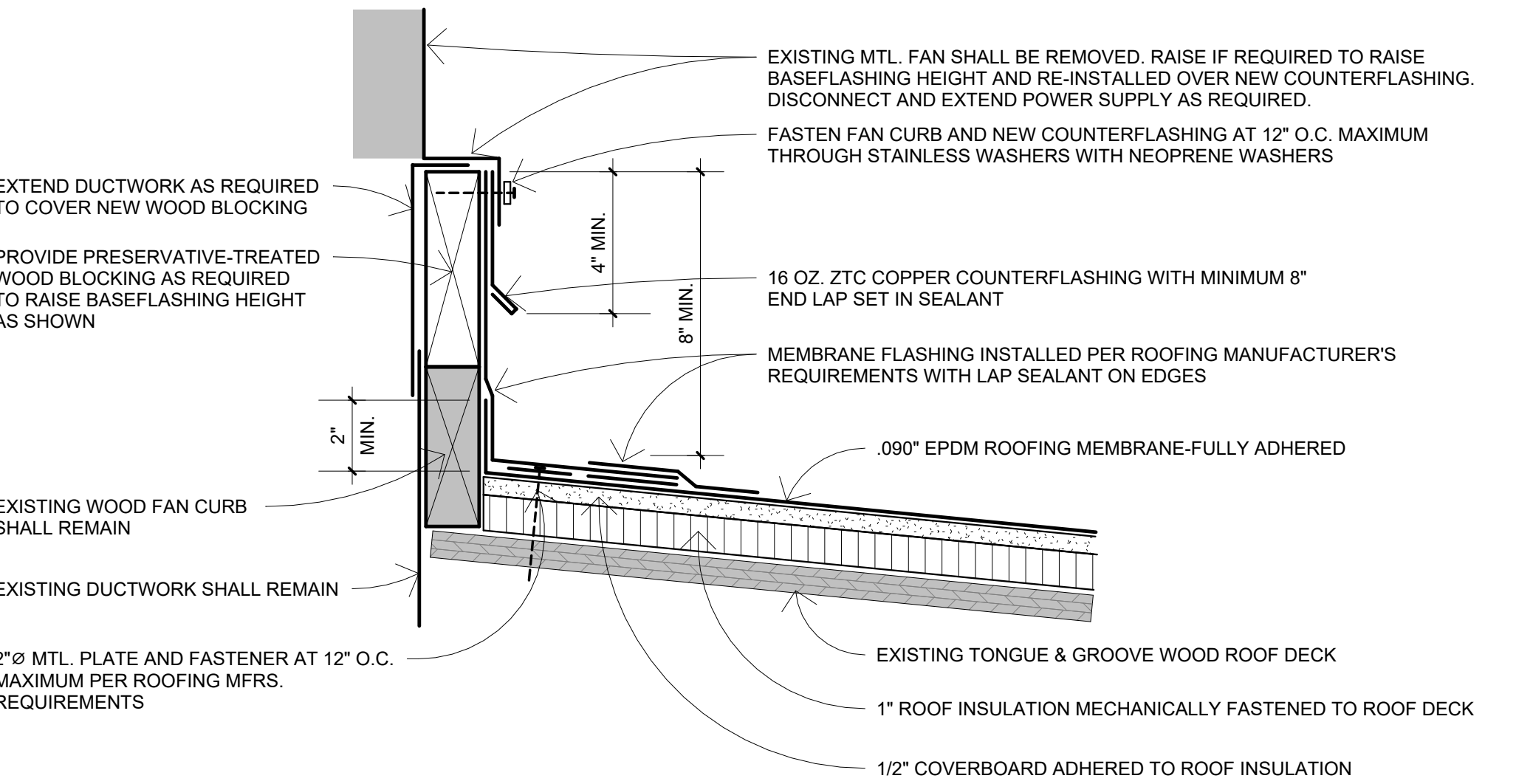

3 FAN CURB FLASHING
A7.52 3" = 1'-0"

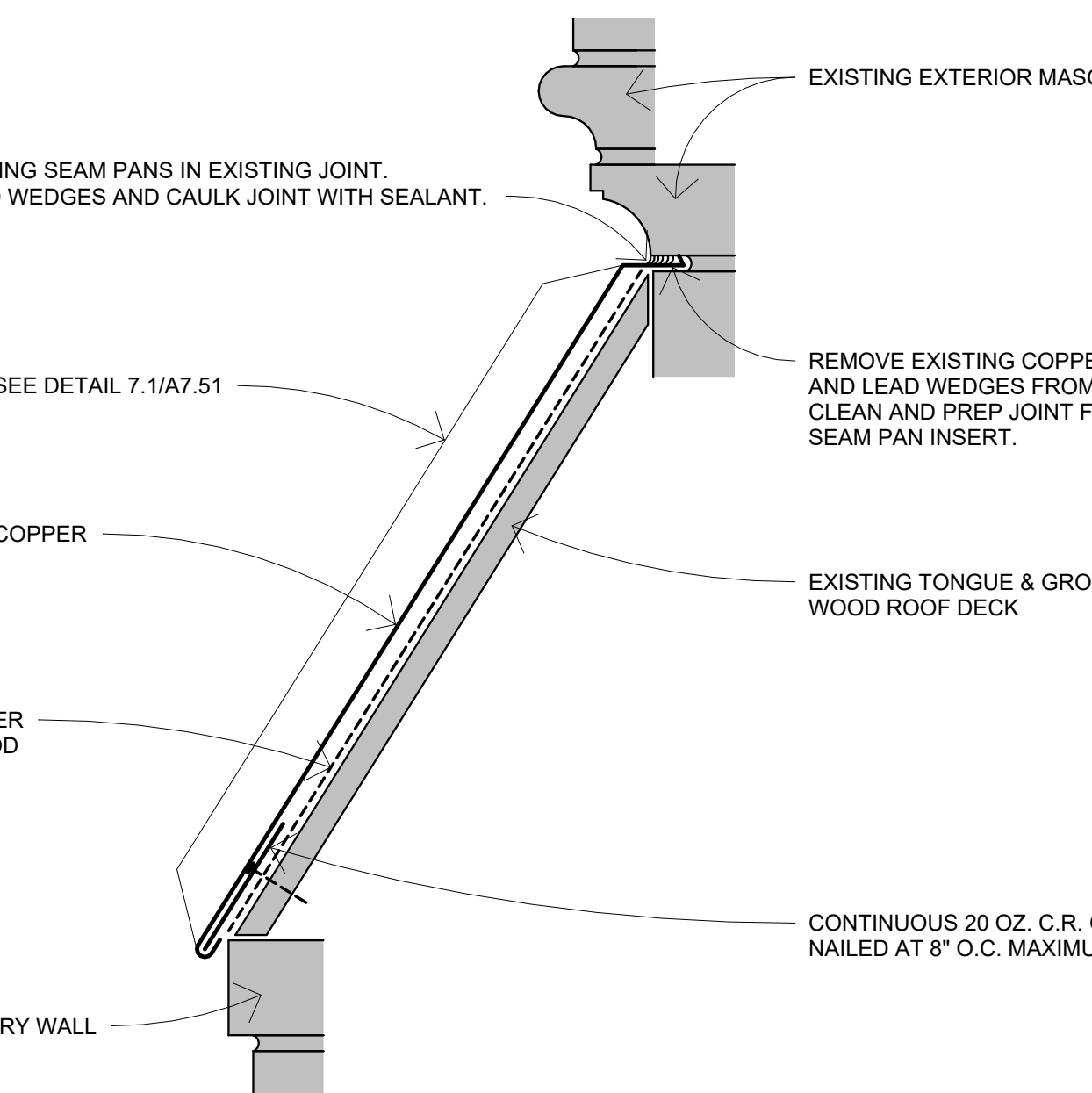

9 TOWER WATER TABLE STANDING SEAM ROOFING
A7.52 3" = 1'-0"

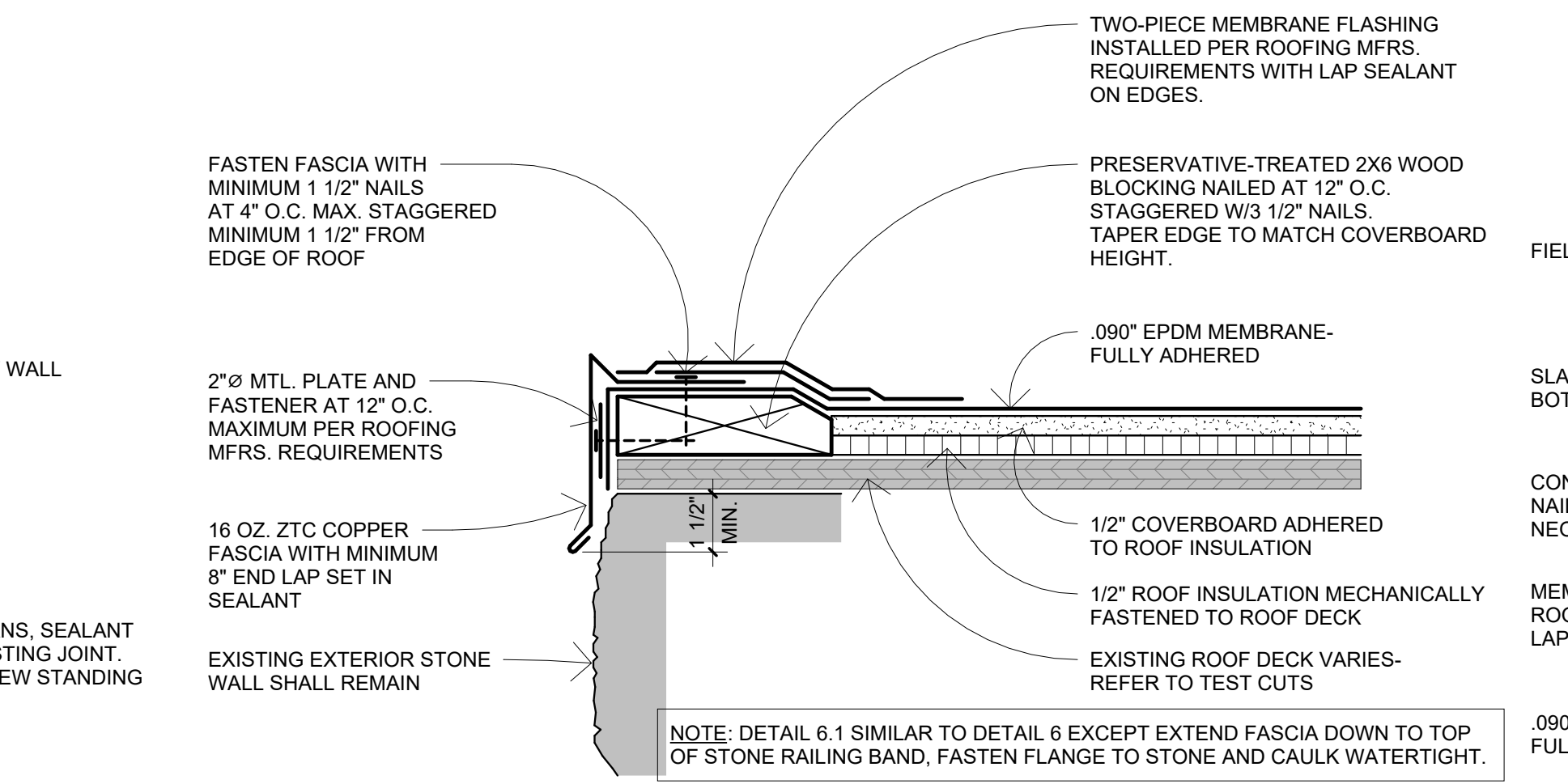

6 TYPICAL SECOND FLOOR EPDM ROOF EDGE FLASHING
A7.52 3" = 1'-0"

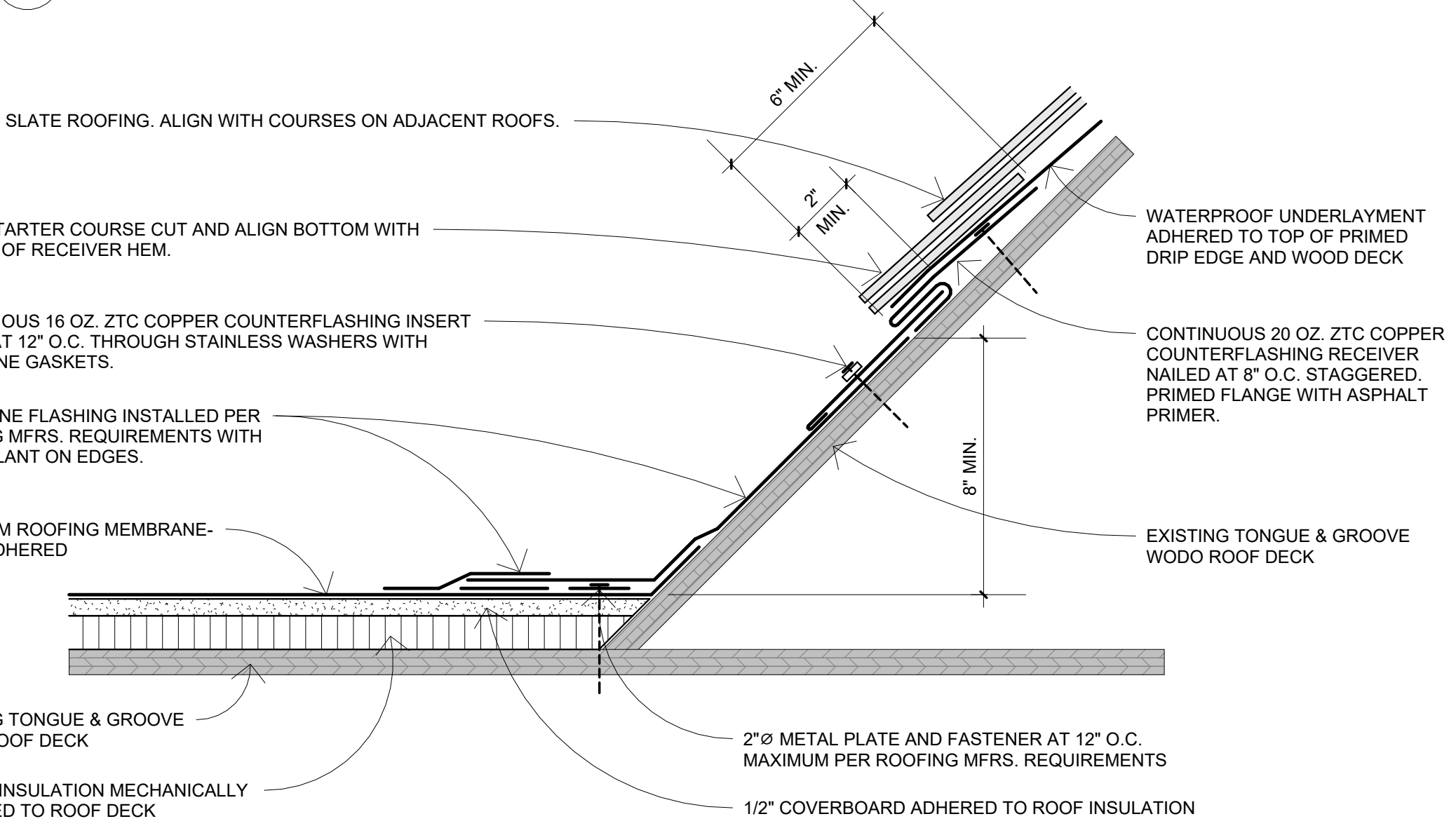

2 ROOF TRANSITION FLASHING - SLATE TO EPDM
A7.52 3" = 1'-0"

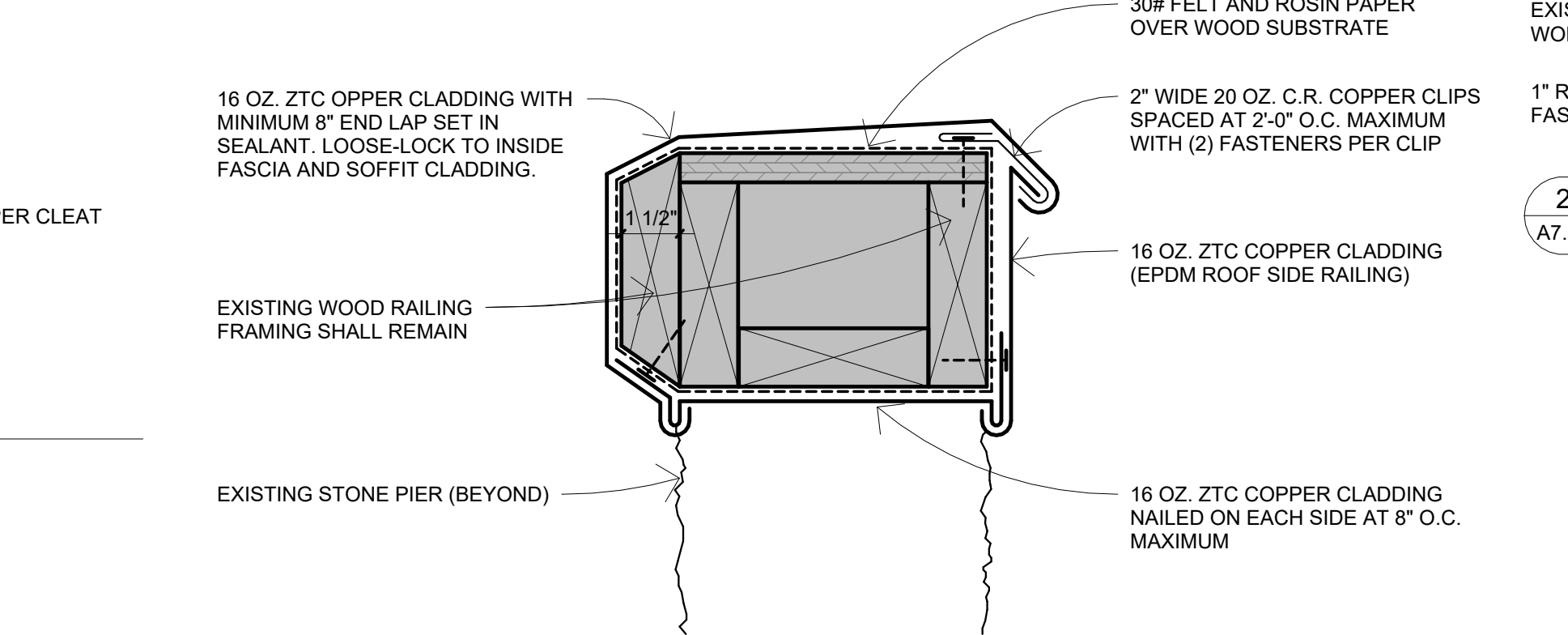

5 TYPICAL PARAPET RAILING CLADDING
A7.52 3" = 1'-0"

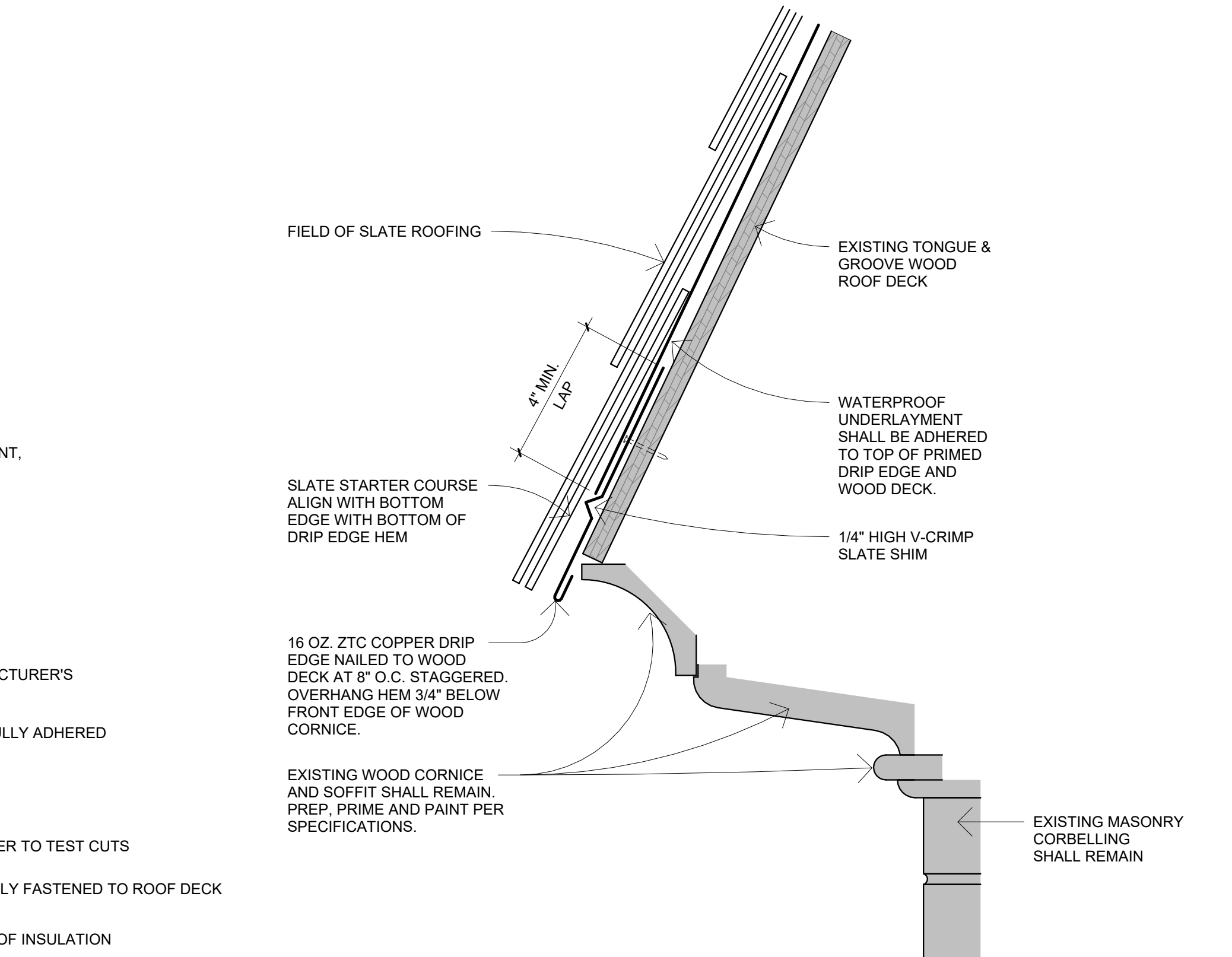

1 TOWER SLATE ROOFING EAVE
A7.52 3" = 1'-0"

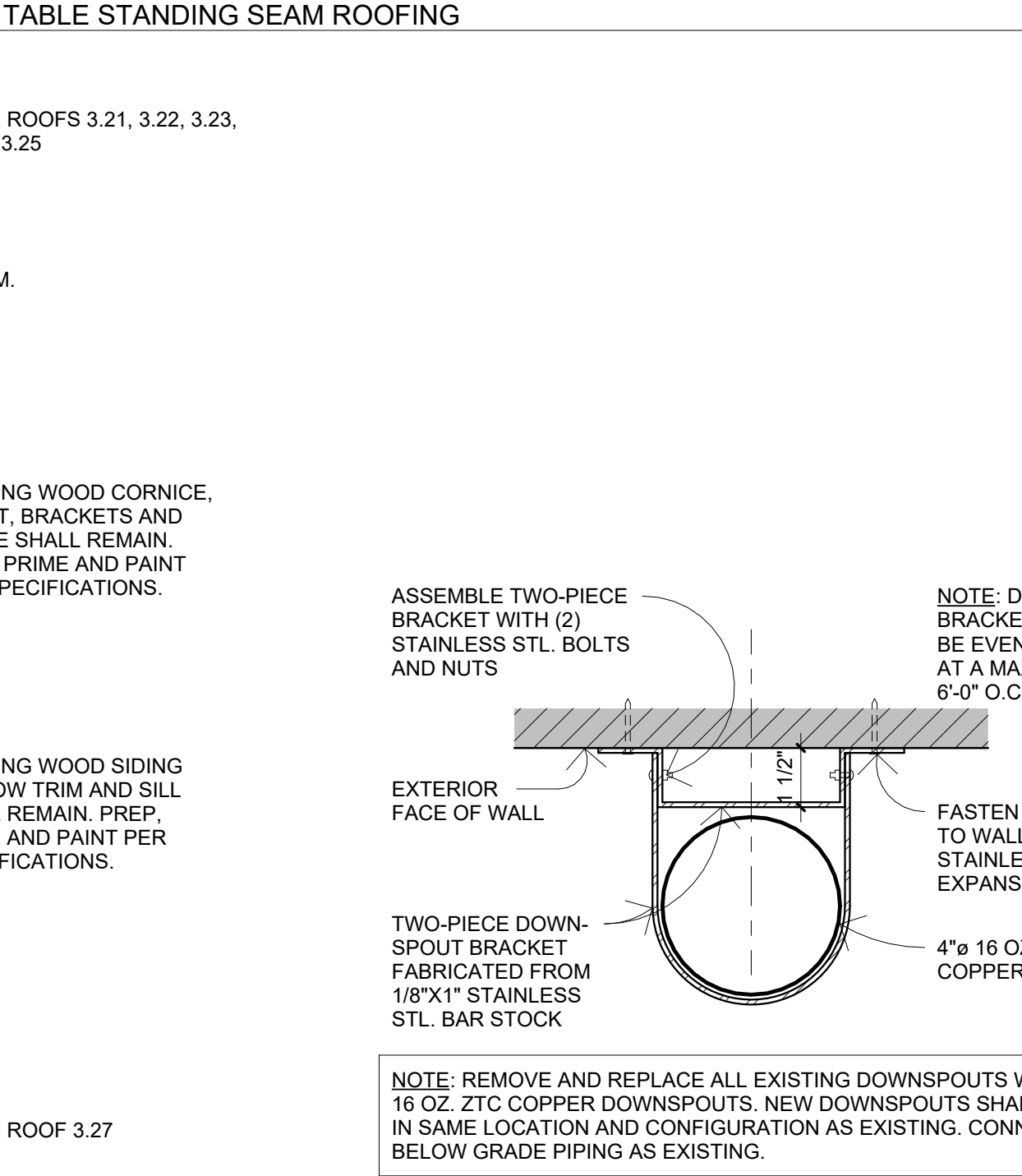

11 TYPICAL THIRD FLOOR CLERESTORY WALL SECTION
A7.52 3/4" = 1'-0"

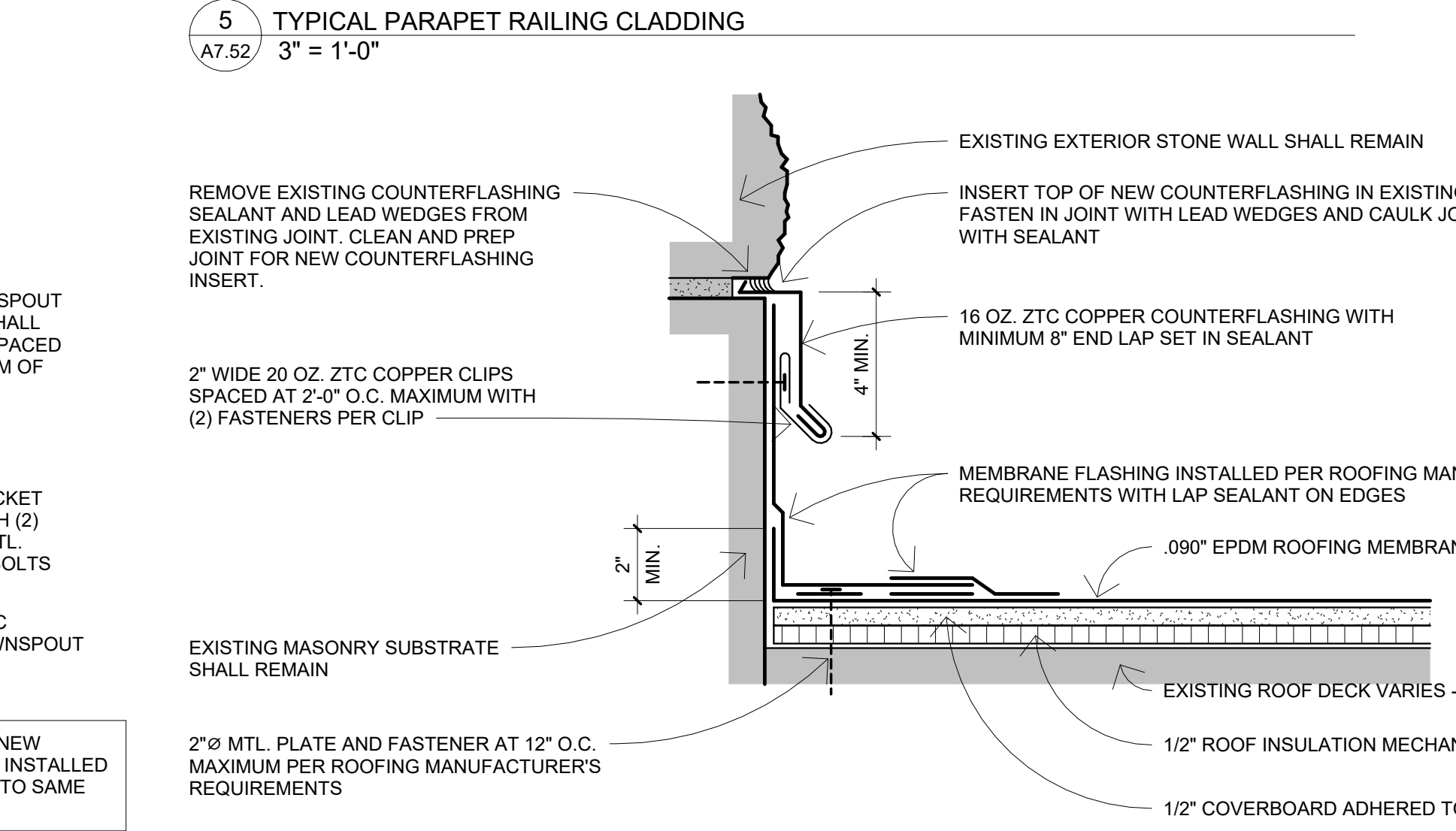

4 TYPICAL SECOND FLOOR EPDM ROOFING BASEFLASHING
A7.52 3" = 1'-0"

8 TYPICAL DOWNSPOUT BRACKET
A7.52 3" = 1'-0"

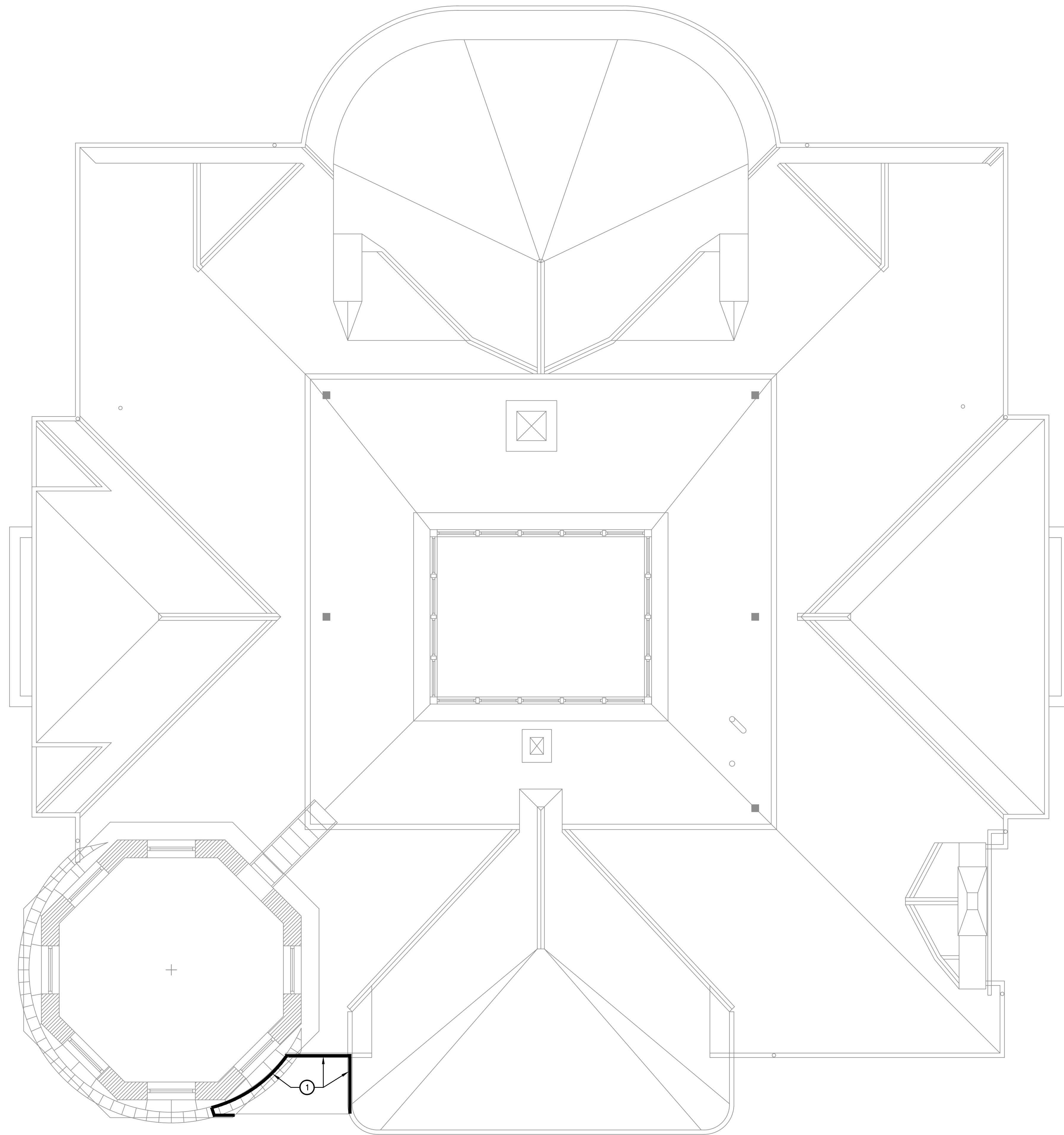

ROOF — THIRD FLOOR
 SCALE: 3/16" = 1'-0"

ASBESTOS ABATEMENT NOTES

- ① ASBESTOS BLACK FLASHING/GLAZING ON BRICK REMOVE AND DISPOSE OF AS NON-FRIABLE ACM.

PROJ. No.: 20170932C55
 DATE: 31 JANUARY 2024

HM-101

ANDRADE ARCHITECTS, LLC.
 ASBESTOS ABATEMENT PLAN
 MERIDEN PUBLIC SCHOOLS - ADMIN ROOF
 22 LIBERTY STREET MERIDEN, CONNECTICUT

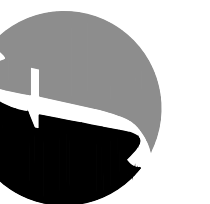

FUSS & O'NEILL
 146 HARTFORD ROAD
 MERIDEN, CONNECTICUT 06440
 860.646.2460
 www.fandob.com

SCALE: HORZ.: 3/16" = 1'-0"
 VERT.:
 DATUM:
 HORZ.:
 VERT.:
 0 2'-0" 5'-0" 10'-0"
 GRAPHIC SCALE

SEAL

No. DATE

DESCRIPTION

DESIGNER REVIEWER